

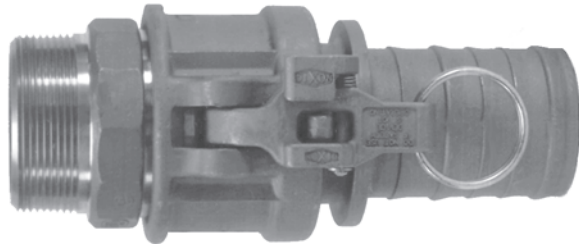

Cam and Groove

EZ Boss-Lock

No more fumbling with clamps, wire, clips or pins.
Just close the handles and the locking
mechanism is engaged.



Unlike other safety couplings . . .

- *The EZ Boss-Lock is extremely **easy to open!!!***
The release lever is under your thumb when you want to open the fitting. **Ergonomic.**
- *The EZ Boss-Lock is resistant to accidental disconnection when being dragged.* The release lever opens in the direction opposite to the cam arm, so movements that tend to open the release lever also tend to close the cam arm!!!
- *The EZ Boss-Lock alerts you if it is not properly engaged.* If the rotating lever is not flush with the handle, it is not properly engaged.
- *The EZ Boss-Lock has no sliding pins to jam.* The EZ Boss-Lock's rotating action helps keep the locking device free of debris.
- *The EZ Boss-Lock has no sliding pins to pop open.* The EZ Boss-Lock is designed to protect critical parts from impact and to withstand rugged use.
- *The EZ Boss-Lock can be supplied with special shanks custom suited to your needs.* The EZ Boss-Lock is available with swaged and PF shank designs for hard to couple chemical hoses.
- *The EZ Boss-Lock cam arm assemblies are made of investment cast stainless steel with plated carbon steel pull rings.*
- *The EZ Boss-Lock is easier to insert into the hose tubes on tank trucks, and easier to use in restricted spaces.* This is due to the smaller maximum O.D. and a more snag free exterior.
- *The EZ Boss-Lock cam arm assemblies can be retrofitted onto undamaged stainless steel Boss-Lock.* This allows you to protect your investment in stainless steel Boss-Lock couplings while you upgrade.
- *The EZ Boss-Lock is made in the USA.*

Cam and Groove Line Drawings

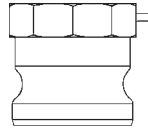

Type A
(male adapter x female NPT)

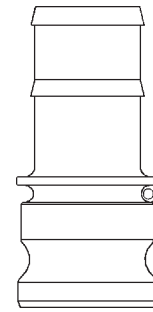

Type E

(male adapter x hose shank)

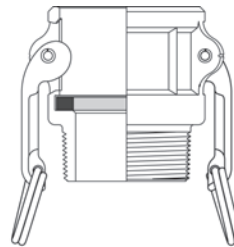

Type B
(female coupler x male NPT)

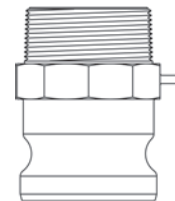

Type F

(male adapter x male NPT)

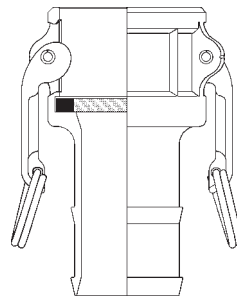

Type C
(female coupler x hose shank)

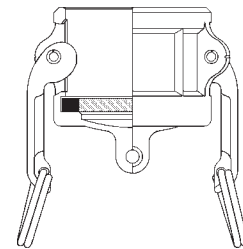

Type DC *
(dust cap)

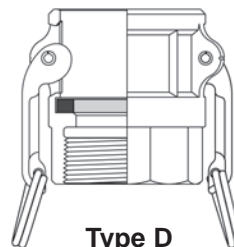

Type D
(female coupler x female NPT)

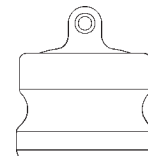

Type DP *
(dust plug)

Note: Line drawings are representative of the Dixon line of cam and groove.

* Dust caps and dust plugs are *not* to be used in pressure applications for safety and environmental reasons.

Warning:
Under no circumstances
should cam and groove couplings
be used for compressed air
or steam service!

**SAFETY
ALERT**