

HMK4 Full Dimensions

Union
60° Cone / 60° Cone

Mates with 92, B1, B2 and B4 style hose fitting

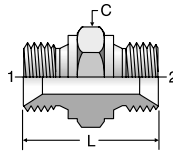

TUBE FITTING PART #	END SIZE		C HEX (mm)	L (mm)	STANDARD Dynamic Pressure (x 1,000 PSI)
	1 BSPP	2 BSPP			S
2HMK4	1/8	1/8	14	23.5	5.1
4-2HMK4	1/4	1/8	19	28.0	5.1
4HMK4	1/4	1/4	19	31.5	5.1
6-4HMK4	3/8	1/4	22	33.2	5.1
6HMK4	3/8	3/8	22	34.7	2.9
8-4HMK4	1/2	1/4	27	36.7	2.9
8-6HMK4	1/2	3/8	27	38.2	2.9
8HMK4	1/2	1/2	27	40.7	2.9
10-8HMK4	5/8	1/2	30	43.2	2.9
10HMK4	5/8	5/8	30	45.2	2.9
12-4HMK4	3/4	1/4	32	39.2	2.9
12-6HMK4	3/4	3/8	32	40.7	2.9
12-8HMK4	3/4	1/2	32	43.2	2.9
12-10HMK4	3/4	5/8	32	45.2	2.9
12HMK4	3/4	3/4	32	45.2	2.9
16-8HMK4	1	1/2	41	46.9	1.7
16-10HMK4	1	5/8	41	48.9	1.7
16-12HMK4	1	3/4	41	48.9	1.7
16HMK4	1	1	41	51.9	1.7
20-12HMK4	1 1/4	3/4	50	57.4	1.5
20-16HMK4	1 1/4	1	50	60.4	1.5
20HMK4	1 1/4	1 1/4	50	61.4	1.5
24-16HMK4	1 1/2	1	55	64.4	1.5
24-20HMK4	1 1/2	1 1/4	55	65.4	1.5
24HMK4	1 1/2	1 1/2	55	67.4	1.5
32-24HMK4	2	1 1/2	70	72.9	1
32HMK4	2	2	70	76.4	1

WMK4WL4NM Full Dimensions

Bulkhead Union
60° Cone / 60° Cone

Mates with 92, B1, B2 and B4 style hose fitting

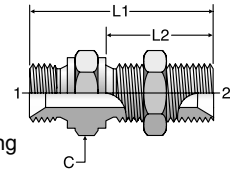

TUBE FITTING PART #	END SIZE		C HEX (mm)	L1 (mm)	L2 (mm)	STANDARD Dynamic Pressure (x 1,000 PSI)
	1 & 2 BSPP	S				
4WMK4WL4NM	1/4		19	46.8	28	5.1
6WMK4WL4NM	3/8		22	52.5	32	5.1
8WMK4WL4NM	1/2		27	59.0	35	2.9
10WMK4WL4NM	5/8		30	61.5	35	2.9
12WMK4WL4NM	3/4		32	64.5	38	2.9
16WMK4WL4NM	1		41	71.2	41	1.7
20WMK4WL4NM	1 1/4		50	82.7	44	1.5
24WMK4WL4NM	1 1/2		55	90.7	48	

Includes Bulkhead nut.

F6MK4 Full Dimensions

Swivel Nut Connector
60° Swivel / 60° Cone

Mates with D9/92, B1, B2 and B4 style hose fitting

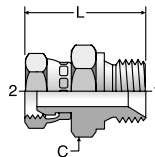

TUBE FITTING PART #	END SIZE		C HEX (mm)	L (mm)	STANDARD Dynamic Pressure (x 1,000 PSI)
	1 BSPP	2 BSPP			S
4-4F6MK4	1/4	1/4	19	36.6	5.1
4-6F6MK4	1/4	3/8	22	38.5	5.1
4-8F6MK4	1/4	1/2	27	42.0	2.9
6-4F6MK4	3/8	1/4	22	38.3	5.1
6-6F6MK4	3/8	3/8	22	40.0	5.1
6-8F6MK4	3/8	1/2	27	43.6	2.9
8-6F6MK4	1/2	3/8	27	43.5	2.9
8-8F6MK4	1/2	1/2	27	46.1	2.9
8-12F6MK4	1/2	3/4	32	48.0	2.9
12-8F6MK4	3/4	1/2	32	48.6	
12-12F6MK4	3/4	3/4	32	50.0	2.9
12-16F6MK4	3/4	1	41	54.3	1.7
16-16F6MK4	1	1	41	57.3	1.7

H6MK4 Full Dimensions

Swivel Nut Union
60° Swivel / 60° Swivel

Mates with D9 style hose fitting

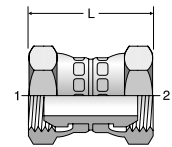

TUBE FITTING PART #	END SIZE		L (mm)	STANDARD Dynamic Pressure (x 1,000 PSI)
	1 BSPP	2 BSPP		S
4H6MK4	1/4	1/4	37.0	5.1
6-4H6MK4	3/8	1/4	38.6	5.1
6H6MK4	3/8	3/8	40.5	5.1
8-4H6MK4	1/2	1/4	41.5	2.9
8-6H6MK4	1/2	3/8	42.9	2.9
8H6MK4	1/2	1/2	45.8	2.9
10H6MK4	5/8	5/8	47.5	2.9
12-8H6MK4	3/4	1/2	48.2	2.9
12H6MK4	3/4	3/4	49.5	2.9
16H6MK4	1	1	57.5	1.7
20H6MK4	1 1/4	1 1/4	66.0	1.5
24H6MK4	1 1/2	1 1/2	70.0	1.5

Dimensions and pressures for reference only, subject to change.

- Visual Index
- How To Order
- Specs
- Assembly / Installation
- Reference Section