

Industrial Sheet Rubber, Matting & Specialty Items Catalog

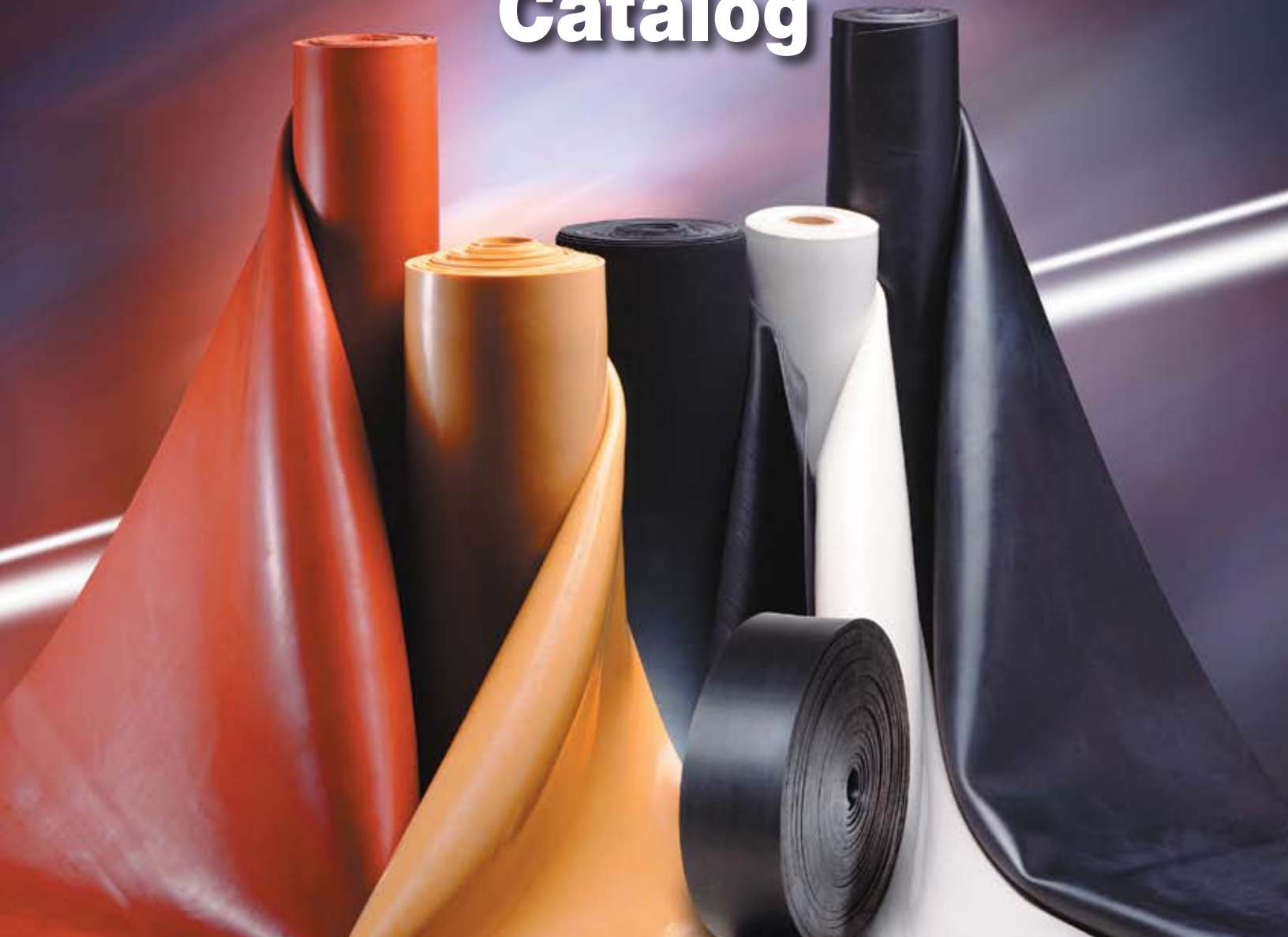

GOODYEAR
RUBBER PRODUCTS INC.

Call Toll Free: **1-866-711-4673**
WebSales@GoodyearRubberProducts.com

**We Ship
World Wide**

General Properties of Neoprene†

- Good weather-resistance
- Moderate resistance to petroleum-based fluids
- Good physical properties.

† Properties shown based on Rubber Manufacturers Association Sheet Rubber Handbook, second edition.

NEOPRENE SHEET

SPECIFICATIONS:

Commercial grade black neoprene sheet, available in four styles:

Style N40: 40 Duro hardness (Shore Durometer A)

Style N50: 50 Duro hardness (Shore Durometer A)

Style N60: 60 Duro hardness (Shore Durometer A)

Style N70: 70 Duro hardness (Shore Durometer A)

Polymer: Chloroprene

Common Name: Neoprene

ISO/ASTM Designation: CR

NEOPRENE SHEET

Neoprene (continued)

Style	ASTM Specification (SI units)	Temp. Range	Durometer	Tensile Strength (PSI)	Elongation (%)	Finish
N40	D 2000 M2BC 407	-20°F to +180°F	35 - 45	900	400%	Plate
N50	D 2000 M2BC 507	-20°F to +180°F	45 - 55	1,000	400%	Plate
N60	D 2000 M2BC 607	-20°F to +180°F	55 - 65	1,000	350%	Plate
N70	D 2000 M2BC 707	-20°F to +180°F	65 - 75	1,000	350%	Plate

ORDERING INFORMATION:

Item Number	Gauge x Width (Inches)	Avg. Length (Linear Ft./Roll)	Approx. Wt./Roll
N40-02 x 36 x 67	1/16" x 36"	67 ft.	96 lbs.
N40-04 x 36 x 67	1/8" x 36"	67 ft.	195 lbs.
N40-06 x 36 x 36	3/16" x 36"	36 ft.	158 lbs.
N40-08 x 36 x 36	1/4" x 36"	36 ft.	210 lbs.
N50-02 x 48 x 67	1/16" x 48"	67 ft.	132 lbs.
N50-04 x 48 x 36	1/8" x 48"	36 ft.	142 lbs.
N50-06 x 48 x 36	3/16" x 48"	36 ft.	213 lbs.
N50-08 x 48 x 18	1/4" x 48"	18 ft.	142 lbs.
N60-01 x 36 x 67	1/32" x 36"	67 ft.	52 lbs.
N60-02 x 36 x 67	1/16" x 36"	67 ft.	99 lbs.
* N60-02 x 36 x 100	1/16" x 36"	100 ft.	147 lbs.
N60-03 x 36 x 67	3/32" x 36"	67 ft.	149 lbs.
N60-04 x 36 x 67	1/8" x 36"	67 ft.	198 lbs.
* N60-04 x 36 x 100	1/8" x 36"	100 ft.	295 lbs.
N60-06 x 36 x 36	3/16" x 36"	36 ft.	161 lbs.
* N60-06 x 36 x 40	3/16" x 36"	40 ft.	179 lbs.
* N60-06 x 36 x 50	3/16" x 36"	50 ft.	223 lbs.
N60-08 x 36 x 36	1/4" x 36"	36 ft.	214 lbs.
* N60-08 x 36 x 40	1/4" x 36"	40 ft.	238 lbs.
* N60-08 x 36 x 50	1/4" x 36"	50 ft.	297 lbs.
N60-12 x 36 x 18	3/8" x 36"	18 ft.	160 lbs.
N60-16 x 36 x 18	1/2" x 36"	18 ft.	214 lbs.
N60-24 x 36 x 18	3/4" x 36"	18 ft.	319 lbs.
N60-32 x 36 x 18	1" x 36"	18 ft.	426 lbs.
N60-02 x 48 x 67	1/16" x 48"	67 ft.	132 lbs.
* N60-02 x 48 x 100	1/16" x 48"	100 ft.	197 lbs.
N60-03 x 48 x 67	3/32" x 48"	67 ft.	200 lbs.
N60-04 x 48 x 36	1/8" x 48"	36 ft.	142 lbs.
* N60-04 x 48 x 50	1/8" x 48"	50 ft.	197 lbs.
N60-06 x 48 x 36	3/16" x 48"	36 ft.	213 lbs.
* N60-06 x 48 x 40	3/16" x 48"	40 ft.	236 lbs.
* N60-06 x 48 x 50	3/16" x 48"	50 ft.	296 lbs.
N60-08 x 48 x 18	1/4" x 48"	18 ft.	142 lbs.
* N60-08 x 48 x 40	1/4" x 48"	40 ft.	316 lbs.
* N60-08 x 48 x 50	1/4" x 48"	50 ft.	394 lbs.
N60-12 x 48 x 18	3/8" x 48"	18 ft.	213 lbs.
* N60-12 x 48 x 30	3/8" x 48"	30 ft.	355 lbs.
N60-16 x 48 x 18	1/2" x 48"	18 ft.	284 lbs.
* N60-16 x 48 x 25	1/2" x 48"	25 ft.	394 lbs.
N60-24 x 48 x 18	3/4" x 48"	18 ft.	425 lbs.
N60-32 x 48 x 18	1" x 48"	18 ft.	567 lbs.
N70-02 x 48 x 67	1/16" x 48"	67 ft.	132 lbs.
N70-04 x 48 x 36	1/8" x 48"	36 ft.	142 lbs.
N70-06 x 48 x 36	3/16" x 48"	36 ft.	213 lbs.

NEOPRENE CLOTH-INSERTED SHEET

General Properties of Neoprene[†]

- Excellent physical properties.

[†] Properties shown based on Rubber Manufacturers Association Sheet Rubber Handbook, second edition.

SPECIFICATIONS:

Commercial grade black neoprene sheet, with nylon reinforcement:

Style NCI: 60 Duro hardness (Shore Durometer A)

Polymer: Chloroprene reinforced with 3.4 oz./sq. yd. nylon fabric

Common Name: Nylon-reinforced Neoprene Sheet

ISO/ASTM Designation: CR

Style	ASTM Specification (SI units)	Temp. Range	Ply	Durometer	Tensile Strength (PSI)	Finish
NCI	D 2000 M2BC 607	-20°F to +180°F	1	55 – 65	1100	Plate
NCI	D 2000 M2BC 607	-20°F to +180°F	2	55 – 65	1100	Plate

ORDERING INFORMATION:

Item Number	Gauge x Width (Inches)	Fabric Plies	Avg. Length (Linear Ft./Roll)	Approx. Wt./Roll
NCI-1P02 x 36 x 67	1/16" x 36"	1 Ply	67 ft.	93 lbs.
NCI-2P04 x 36 x 36	1/8" x 36"	2 Ply	36 ft.	98 lbs.
NCI-2P06 x 36 x 36	3/16" x 36"	2 Ply	36 ft.	146 lbs.
NCI-2P08 x 36 x 36	1/4" x 36"	2 Ply	36 ft.	196 lbs.

NOTE: This product is also available in 48" width . . . contact Kuriyama of America.

NITRILE SHEET

General Properties of Nitrile[†]

- Excellent resistance to petroleum-based fluids
- Good physical properties.

[†] Properties shown based on Rubber Manufacturers Association Sheet Rubber Handbook, second edition.

SPECIFICATIONS:

Commercial grade black nitrile sheet:

Style B60: 60 Duro hardness (Shore Durometer A)

Polymer: Nitrile-Butadiene

Common Name: Nitrile, Buna-N

ISO/ASTM Designation: NBR

Style	ASTM Specification (SI units)	Temp. Range	Durometer	Tensile Strength (PSI)	Elongation (%)	Finish
B60	D 2000 M5BG 607	-30°F to +200°F	55 – 65	1000	350%	Plate

ORDERING INFORMATION:

Item Number	Gauge x Width (Inches)	Avg. Length (Linear Ft./Roll)	Approx. Wt./Roll
B60-01 x 36 x 67	1/32" x 36"	67 ft.	56 lbs.
B60-02 x 36 x 67	1/16" x 36"	67 ft.	100 lbs.
B60-03 x 36 x 67	3/32" x 36"	67 ft.	150 lbs.
B60-04 x 36 x 67	1/8" x 36"	67 ft.	200 lbs.
B60-06 x 36 x 36	3/16" x 36"	36 ft.	161 lbs.
B60-08 x 36 x 36	1/4" x 36"	36 ft.	215 lbs.
* B60-02 x 48 x 67	1/16" x 48"	67 ft.	133 lbs.
* B60-04 x 48 x 67	1/8" x 48"	67 ft.	266 lbs.

General Properties of Nitrile†

- Excellent resistance to petroleum-based fluids
- Good physical properties.

† Properties shown based on Rubber Manufacturers Association Sheet Rubber Handbook, second edition.

FDA WHITE NITRILE SHEET

SPECIFICATIONS:

Food grade white nitrile sheet, made from FDA-approved materials (Title 21 Food and Drug S 177.26000):

Style W60: 60 Duro hardness (Shore Durometer A)

Polymer: Nitrile-Butadiene

Common Name: Nitrile, Buna-N

ISO/ASTM Designation: NBR

Style	ASTM Specification (SI units)	Temp. Range	Durometer	Tensile Strength (PSI)	Elongation (%)	Finish
W60	D 2000 M1BG 608	-31°F to +230°F	55 – 65	1100	400%	Plate

ORDERING INFORMATION:

Item Number	Gauge x Width (Inches)	Avg. Length (Linear Ft./Roll)	Approx. Wt./Roll
W60-02 x 36 x 67	1/16" x 36"	67 ft.	92 lbs.
W60-03 x 36 x 67	3/32" x 36"	67 ft.	137 lbs.
W60-04 x 36 x 36	1/8" x 36"	36 ft.	98 lbs.
W60-06 x 36 x 18	3/16" x 36"	18 ft.	74 lbs.
W60-08 x 36 x 18	1/4" x 36"	18 ft.	98 lbs.
W60-02 x 48 x 36	1/16" x 48"	36 ft.	66 lbs.
W60-04 x 48 x 36	1/8" x 48"	36 ft.	131 lbs.
W60-06 x 48 x 18	3/16" x 48"	18 ft.	98 lbs.
W60-08 x 48 x 18	1/4" x 48"	18 ft.	131 lbs.

General Properties of SBR†

- Excellent physical properties.

† Properties shown based on Rubber Manufacturers Association Sheet Rubber Handbook, second edition.

BLACK CLOTH-INSERTED SBR SHEET

SPECIFICATIONS:

Commercial grade black SBR sheet, with cloth reinforcement:

Style CI: 60 Duro hardness (Shore Durometer A)

Polymer: Styrene-Butadiene Rubber reinforced with 3.4 oz./sq. yd. nylon fabric

Common Name: Cloth-reinforced Black Rubber Sheet

ISO/ASTM Designation: SBR

Style	ASTM Specification (SI units)	Temp. Range	Ply	Durometer	Tensile Strength (PSI)	Finish
CI	D 2000 M2AA 603	-20°F to +170°F	1	55 – 65	600	Plate
CI	D 2000 M2AA 603	-20°F to +170°F	2	55 – 65	600	Plate
CI	D 2000 M2AA 603	-20°F to +170°F	3	55 – 65	600	Plate
CI	D 2000 M2AA 603	-20°F to +170°F	4	55 – 65	600	Plate

ORDERING INFORMATION:

Item Number	Gauge x Width (Inches)	Fabric Plies	Avg. Length (Linear Ft./Roll)	Approx. Wt./Roll
CI-1P02 x 48 x 67	1/16" x 48"	1 Ply	67 ft.	132 lbs.
CI-1P04 x 48 x 36	1/8" x 48"	1 Ply	36 ft.	140 lbs.
CI-2P04 x 48 x 36	1/8" x 48"	2 Ply	36 ft.	140 lbs.
CI-2P06 x 48 x 18	3/16" x 48"	2 Ply	18 ft.	107 lbs.

BLACK SBR SHEET

General Properties of SBR†

- Good physical properties.

† Properties shown based on Rubber Manufacturers Association Sheet Rubber Handbook, second edition.

SPECIFICATIONS:

Commercial grade black SBR sheet:

Style BL60: 65 Duro hardness (Shore Durometer A)

Polymer: Styrene-Butadiene

Common Name: Black Rubber Sheet

ISO/ASTM Designation: SBR

Style	ASTM Specification (SI units)	Temp. Range	Durometer	Tensile Strength (PSI)	Elongation (%)	Finish
BL60	D 2000 M1AA 604	-13°F to +158°F	60 – 70	600	200%	Plate

ORDERING INFORMATION:

Item Number	Gauge x Width (Inches)	Avg. Length (Linear Ft./Roll)	Approx. Wt./Roll
BL60-02 x 48 x 67	1/16" x 48"	67 ft.	131 lbs.
BL60-04 x 48 x 36	1/8" x 48"	36 ft.	140 lbs.
BL60-08 x 48 x 18	1/4" x 48"	18 ft.	140 lbs.

RED SBR SHEET Plate & Fabric Finish

General Properties of SBR†

- Good physical properties.

† Properties shown based on Rubber Manufacturers Association Sheet Rubber Handbook, second edition.

SPECIFICATIONS:

**Commercial grade red SBR sheet,
Plate or Fabric Finish:**

Style R75: 70 Duro hardness (Shore Durometer A)

Style RF75: 70 Duro hardness (Shore Durometer A)

Polymer: Styrene-Butadiene

Common Name: Red Rubber Sheet

ISO/ASTM Designation: SBR

Meets D1330 Grade 1

Style	ASTM Specification (SI units)	Temp. Range	Durometer	Tensile Strength (PSI)	Elongation (%)	Finish
R75	D 2000 M1AA 705	-22°F to +158°F	65 – 75	600	200%	Plate
RF75	D 2000 M1AA 705	-22°F to +158°F	65 – 75	600	200%	Fabric Impression

ORDERING INFORMATION:

Item Number	Gauge x Width (Inches)	Avg. Length (Linear Ft./Roll)	Approx. Wt./Roll
Plate Finish	Fabric Impression		
R75-02 x 36 x 67	RF75-02 x 36 x 67	1/16" x 36"	106 lbs.
R75-04 x 36 x 36	RF75-04 x 36 x 36	1/8" x 36"	114 lbs.
R75-06 x 36 x 36	RF75-06 x 36 x 36	3/16" x 36"	171 lbs.
R75-08 x 36 x 18	RF75-08 x 36 x 18	1/4" x 36"	114 lbs.
R75-02 x 48 x 67	RF75-02 x 48 x 67	1/16" x 48"	141 lbs.
R75-04 x 48 x 36	RF75-04 x 48 x 36	1/8" x 48"	140 lbs.
R75-06 x 48 x 36	RF75-06 x 48 x 36	3/16" x 48"	171 lbs.
R75-08 x 48 x 18	RF75-08 x 48 x 18	1/4" x 48"	140 lbs.

General Properties of VITON®

- Excellent resistance to many concentrated acids.
- Excellent resistance to heat.

† Properties shown based on Rubber Manufacturers Association Sheet Rubber Handbook, second edition.

SPECIFICATIONS:

Commercial grade black VITON® sheet:

Style VI70: 72 Duro hardness (Shore Durometer A)

Style	ASTM Specification (SI units)	Temp. Range	Durometer	Tensile Strength (PSI)	Elongation (%)	Finish
VI70	D 2000 M1HK 704	-14°F to +482°F	72	600	165%	Plate

ORDERING INFORMATION:

Item Number	Gauge x Width (Inches)	Avg. Length (Linear Ft./Roll)	Approx. Wt./Roll
VI70-01 x 36 x 30	1/32" x 36"	30 ft.	29 lbs.
* VI70-02 x 36 x 10	1/16" x 36"	10 ft.	19 lbs.
VI70-02 x 36 x 30	1/16" x 36"	30 ft.	58 lbs.
* VI70-03 x 36 x 10	3/32" x 36"	10 ft.	28 lbs.
VI70-03 x 36 x 30	3/32" x 36"	30 ft.	85 lbs.
* VI70-04 x 36 x 10	1/8" x 36"	10 ft.	37 lbs.
* VI70-04 x 36 x 15	1/8" x 36"	15 ft.	55 lbs.
VI70-04 x 36 x 30	1/8" x 36"	30 ft.	110 lbs.
* VI70-06 x 36 x 10	3/16" x 36"	10 ft.	57 lbs.
VI70-06 x 36 x 30	3/16" x 36"	30 ft.	170 lbs.
* VI70-08 x 36 x 10	1/4" x 36"	10 ft.	74 lbs.
* VI70-08 x 36 x 15	1/4" x 36"	15 ft.	111 lbs.
VI70-08 x 36 x 30	1/4" x 36"	30 ft.	222 lbs.

*New Stocked Lengths

VITON® SHEET

Note: VITON® is a registered trademark of DuPont Dow Elastomers.

Polymer: Hexafluoropropylene Vinylidene Fluoride

Common Name: Viton

ISO/ASTM Designation: FKM

General Properties of HYPALON®

- Excellent resistance to oxidation and outstanding resistance to strong sunlight and ozone.
- Good resistance to general acids, oils and greases.

† Properties shown based on Rubber Manufacturers Association Sheet Rubber Handbook, second edition.

SPECIFICATIONS:

HYPALON® rubber sheet:

Style HY60: 60 Duro hardness (Shore Durometer A)

Style	ASTM Specification (SI units)	Temp. Range	Durometer	Tensile Strength (PSI)	Elongation (%)	Finish
HY60	D 2000 M1CE 614	-31°F to +257°F	55 – 65	1400	350%	Plate

ORDERING INFORMATION:

Item Number	Gauge x Width (Inches)	Avg. Length (Linear Ft./Roll)	Approx. Wt./Roll
HY60-02 x 36 x 67	1/16" x 36"	67 ft.	88 lbs.

HYPALON® SHEET

Note: HYPALON® is a registered trademark of DuPont Dow Elastomers.

Polymer: Chlorosulphonated Polyethylene

Common Name: Hypalon

ISO/ASTM Designation: CSM

EPDM SHEET

General Properties of EPDM[†]

- Good ozone, chemical and aging resistance

[†] Properties shown based on Rubber Manufacturers Association Sheet Rubber Handbook, second edition.

SPECIFICATIONS:

Commercial grade black EPDM sheet:

Style E60: 60 Duro hardness (Shore Durometer A)

Polymer: Ethylene-Propylene-Diene-Monomer

Common Name: Ethylene-Propylene Rubber

ISO/ASTM Designation: EPDM

Style	ASTM Specification (SI units)	Temp. Range	Durometer	Tensile Strength (PSI)	Elongation (%)	Finish
E60	D 2000 M2BA 608	-20°F to +230°F	55 – 65	1100	350%	Plate

ORDERING INFORMATION:

Item Number	Gauge x Width (Inches)	Avg. Length (Linear Ft./Roll)	Approx. Wt./Roll
E60-02 x 36 x 67	1/16" x 36"	67 ft.	92 lbs.
E60-04 x 36 x 67	1/8" x 36"	67 ft.	183 lbs.
E60-06 x 36 x 36	3/16" x 36"	36 ft.	148 lbs.
E60-08 x 36 x 36	1/4" x 36"	36 ft.	197 lbs.
E60-02 x 48 x 67	1/16" x 48"	67 ft.	122 lbs.
E60-04 x 48 x 67	1/8" x 48"	67 ft.	244 lbs.
E60-06 x 48 x 36	3/16" x 48"	36 ft.	197 lbs.
E60-08 x 48 x 36	1/4" x 48"	36 ft.	263 lbs.

SILICONE SHEET

General Properties of Silicone[†]

- Excellent resistance to heat.
- Good physical properties.

[†] Properties shown based on Rubber Manufacturers Association Sheet Rubber Handbook, second edition.

SPECIFICATIONS:

Commercial grade red silicone sheet:

Style SIL60: 60 Duro hardness (Shore Durometer A)

Polymer: Polydimethylsiloxane

Common Name: Silicone

ISO/ASTM Designation: FE

Style	ASTM Specification (SI units)	Temp. Range	Durometer	Tensile Strength (PSI)	Elongation (%)	Finish
SIL60	D 2000 M2FE 607 B37	-94°F to +392°F	55 – 65	1100	300%	Plate

ORDERING INFORMATION:

Item Number	Gauge x Width (Inches)	Avg. Length (Linear Ft./Roll)	Approx. Wt./Roll
SIL60-01 x 36 x 35	1/32" x 36"	35 ft.	22 lbs.
SIL60-02 x 36 x 35	1/16" x 36"	35 ft.	44 lbs.
SIL60-03 x 36 x 35	3/32" x 36"	35 ft.	67 lbs.
SIL60-04 x 36 x 35	1/8" x 36"	35 ft.	89 lbs.
SIL60-06 x 36 x 35	3/16" x 36"	35 ft.	133 lbs.
SIL60-08 x 36 x 35	1/4" x 36"	35 ft.	178 lbs.
SIL60-01 x 48 x 35	1/32" x 48"	35 ft.	30 lbs.
SIL60-02 x 48 x 35	1/16" x 48"	35 ft.	59 lbs.
SIL60-03 x 48 x 35	3/32" x 48"	35 ft.	88 lbs.

General Properties of Pure Gum†

- Excellent physical properties
- Excellent abrasion-resistance
- Excellent low temperature resistance
- Good resistance to most acids

† Properties shown based on Rubber Manufacturers Association Sheet Rubber Handbook, second edition.

TAN PURE GUM SHEET

SPECIFICATIONS:

Tan pure gum rubber sheet:

Style GF40: 40 Duro hardness (Shore Durometer A)

Polymer: Isoprene rubber (natural)

Common Name: Natural Rubber Sheet

ISO/ASTM Designation: NR

Style	ASTM Specification (SI units)	Temp. Range	Durometer	Tensile Strength (PSI)	Elongation (%)	Finish
GF40	D 2000 M1AA 424	-40°F to +176°F	35 – 45	3400	600%	Plate

ORDERING INFORMATION:

Item Number	Gauge x Width (Inches)	Avg. Length (Linear Ft./Roll)	Approx. Wt./Roll
GF40-02 x 36 x 67	1/16" x 36"	67 ft.	65 lbs.
GF40-04 x 36 x 67	1/8" x 36"	67 ft.	131 lbs.
GF40-06 x 36 x 67	3/16" x 36"	67 ft.	196 lbs.
GF40-08 x 36 x 36	1/4" x 36"	36 ft.	140 lbs.
GF40-12 x 36 x 36	3/8" x 36"	36 ft.	211 lbs.
GF40-16 x 36 x 18	1/2" x 36"	18 ft.	140 lbs.
GF40-24 x 36 x 18	3/4" x 36"	18 ft.	211 lbs.
GF40-32 x 36 x 18	1" x 36"	18 ft.	281 lbs.
GF40-02 x 48 x 67	1/16" x 48"	67 ft.	87 lbs.
GF40-04 x 48 x 36	1/8" x 48"	36 ft.	94 lbs.
GF40-06 x 48 x 36	3/16" x 48"	36 ft.	140 lbs.
GF40-08 x 48 x 18	1/4" x 48"	18 ft.	94 lbs.

General Properties of Red Gum†

- Excellent physical properties
- High abrasion-resistance
- Good resilience

† Properties shown based on Rubber Manufacturers Association Sheet Rubber Handbook, second edition.

RED PURE GUM SHEET

SPECIFICATIONS:

Red pure gum rubber sheet:

Style RG45: 45 Duro hardness (Shore Durometer A)

Polymer: Isoprene rubber (natural)

Common Name: Natural Rubber Sheet

ISO/ASTM Designation: NR

Style	ASTM Specification (SI units)	Temp. Range	Durometer	Tensile Strength (PSI)	Elongation (%)	Finish
RG45	D 2000 M1AA 414	-40°F to +185°F	40 – 50	2400	600%	Plate

ORDERING INFORMATION:

Item Number	Gauge x Width (Inches)	Avg. Length (Linear Ft./Roll)	Approx. Wt./Roll
RG45-12 x 48 x 67	3/8" x 48"	67 ft.	211 lbs.

BLACK "V" CORRUGATED RUBBER MATTING

SPECIFICATIONS: Blended SBR/Natural Rubber

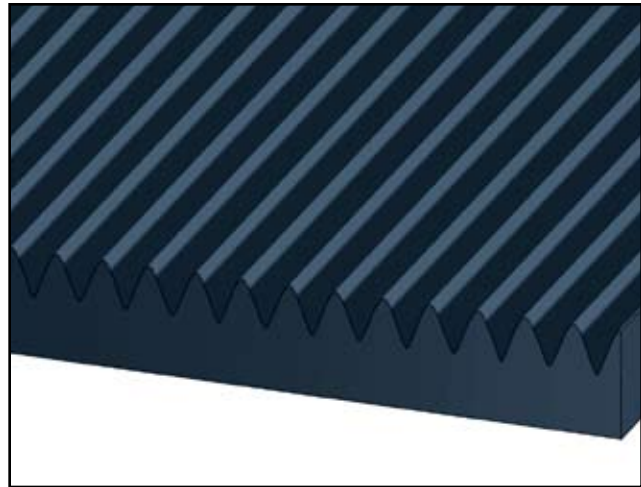

Provides floor protection in entrances and hallways in offices and plants. "V" corrugation allows for easy cleaning.

ORDERING INFORMATION:

Item Number	Gauge x Width (Inches)	Temp. Range	Average Length (Linear Ft./Roll)	Approx. Wt./Roll
MAT-04 X 24 X 75	1/8" X 24"	-13°F to +158°F	75 ft.	101 lbs.
MAT-04 X 36 X 75	1/8" X 36"	-13°F to +158°F	75 ft.	152 lbs.
MAT-04 X 48 X 75	1/8" X 48"	-13°F to +158°F	75 ft.	203 lbs.

BLACK WIDE-RIBBED PREMIUM RUBBER MATTING



Made with a blend of SBR/Natural Rubber for tough, long lasting service.

This premium wide-ribbed rubber matting is ideal for many uses:

- Factory work stations
- Hallway runners
- Protective covering for carpets

Features:

- Easy to maintain
- Easy to clean:
 - ★ Wet Mop
 - ★ Garden Hose
 - ★ Household Broom
 - ★ Vacuum Cleaner

ORDERING INFORMATION:

Item Number	Gauge x Width (Inches)	Temp. Range	Average Length (Linear Ft./Roll)	Approx. Wt./Roll
-------------	------------------------	-------------	----------------------------------	------------------

HONEYCOMB COMFORT MATTING

General Properties of Nitrile[†]

- Excellent resistance to petroleum-based fluids
- Good physical properties.

General Properties of SBR[†]

- Good physical properties.

[†] Properties shown based on Rubber Manufacturers Association Sheet Rubber Handbook, second edition.

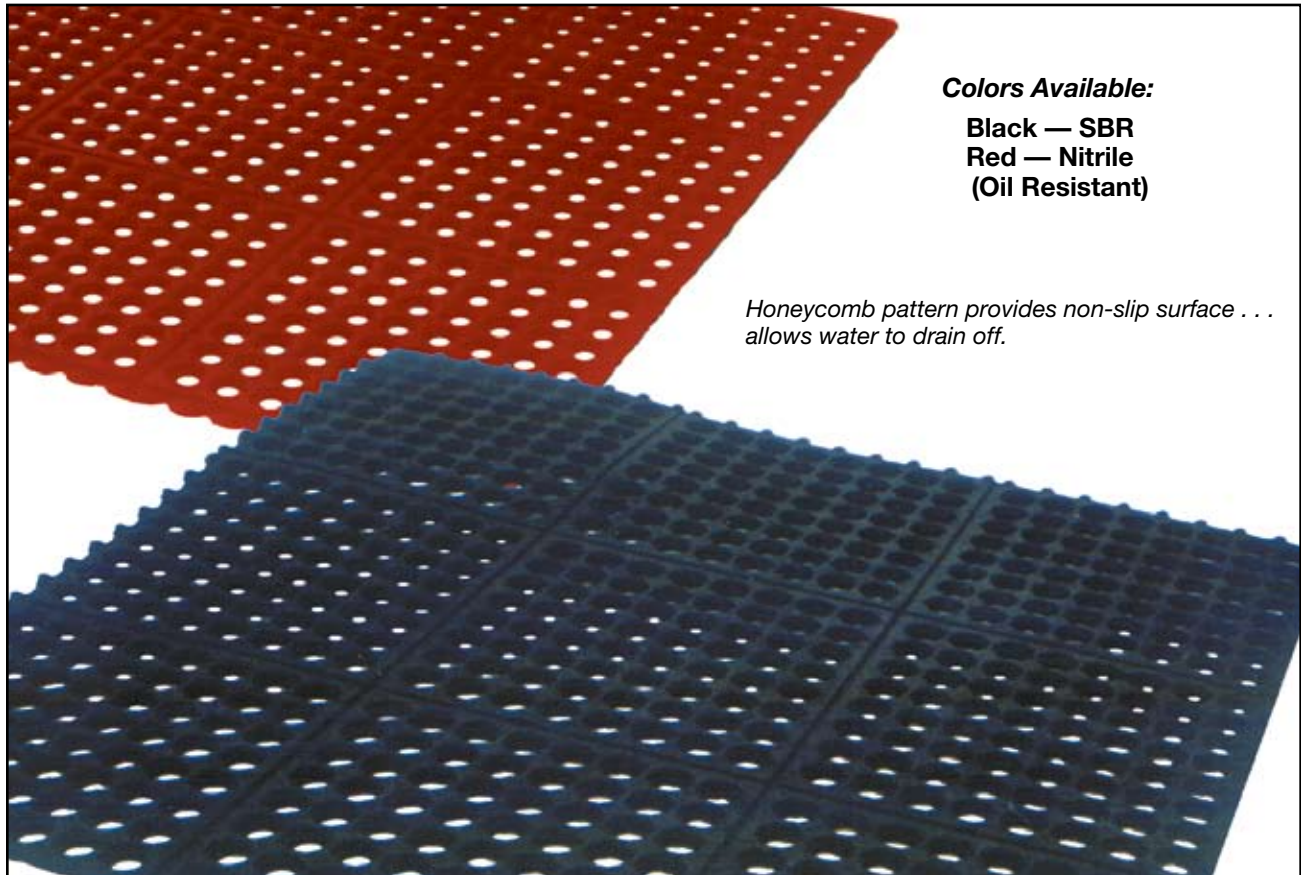

Colors Available:

Black — SBR
Red — Nitrile
(Oil Resistant)

Honeycomb pattern provides non-slip surface . . . allows water to drain off.

SPECIFICATIONS:

Hardness: 55 Duro hardness (Shore Durometer A)

Tensile Strength: 240 PSI

Elongation: 300%

Cold Resistance: -20° F.

Black Comfort Matting:

Polymer: Styrene-Butadiene

Common Name: Black Rubber

ISO/ASTM Designation: SBR

Red Comfort Matting:

Polymer: Nitrile-Butadiene

Common Name: Nitrile, Buna-N

ISO/ASTM Designation: NBR

Item No.	Gauge Thickness	Size	Approx. Weight per Piece
BLKHCMAT-3X3	5/8"	3' X 3'	16 lbs.
REDHCMAT-3X3	5/8"	3' X 3'	16 lbs.

GOODYEAR
RUBBER PRODUCTS INC.

Call Toll Free: 1-866-711-4673
WebSales@GoodyearRubberProducts.com

**We Ship
World Wide**

SKIRTBOARD RUBBER

General Properties of Skirtboard Rubber

- Excellent abrasion-resistance
- Excellent weather-resistance

PACKAGING: 50 Ft. Rolls

SPECIFICATIONS:

Blended SBR/NR slit sheet,
Plate Finish:

Style SK60: 60 Duro hardness (Shore Durometer A)

Polymer: Styrene-Butadiene and Isoprene Rubber, Natural

Color: Black

Common Name: Skirtboard Rubber

ISO/ASTM Designation: SBR/NR

Style	ASTM Specification (SI units)	Temp. Range	Durometer	Tensile Strength (PSI)	Elongation (%)	Finish
SK60	D 2000 M1AA 608	-22°F to +158°F	55 – 65	1100	400%	Plate

ORDERING INFORMATION:

Item Number	Gauge x Width (Inches)	Avg. Length (Linear Ft./Roll)	Approx. Wt./Roll
SK60-08 x 3 x 50	1/4" x 3"	50 ft.	23 lbs.
SK60-08 x 4 x 50	1/4" x 4"	50 ft.	30 lbs.
SK60-08 x 5 x 50	1/4" x 5"	50 ft.	38 lbs.
SK60-08 x 6 x 50	1/4" x 6"	50 ft.	45 lbs.
SK60-08 x 8 x 50	1/4" x 8"	50 ft.	61 lbs.
SK60-08 x 10 x 50	1/4" x 10"	50 ft.	76 lbs.
SK60-08 x 12 x 50	1/4" x 12"	50 ft.	91 lbs.
SK60-12 x 3 x 50	3/8" x 3"	50 ft.	34 lbs.
SK60-12 x 4 x 50	3/8" x 4"	50 ft.	45 lbs.
SK60-12 x 5 x 50	3/8" x 5"	50 ft.	57 lbs.
SK60-12 x 6 x 50	3/8" x 6"	50 ft.	68 lbs.
SK60-12 x 8 x 50	3/8" x 8"	50 ft.	91 lbs.
SK60-12 x 10 x 50	3/8" x 10"	50 ft.	114 lbs.
SK60-12 x 12 x 50	3/8" x 12"	50 ft.	136 lbs.
SK60-16 x 3 x 50	1/2" x 3"	50 ft.	45 lbs.
SK60-16 x 4 x 50	1/2" x 4"	50 ft.	61 lbs.
SK60-16 x 5 x 50	1/2" x 5"	50 ft.	76 lbs.
SK60-16 x 6 x 50	1/2" x 6"	50 ft.	91 lbs.
SK60-16 x 8 x 50	1/2" x 8"	50 ft.	121 lbs.
SK60-16 x 10 x 50	1/2" x 10"	50 ft.	151 lbs.
SK60-16 x 12 x 50	1/2" x 12"	50 ft.	182 lbs.
SK60-24 x 3 x 50	3/4" x 3"	50 ft.	68 lbs.
SK60-24 x 6 x 50	3/4" x 6"	50 ft.	136 lbs.
SK60-24 x 8 x 50	3/4" x 8"	50 ft.	182 lbs.
SK60-24 x 9 x 50	3/4" x 9"	50 ft.	205 lbs.
SK60-24 x 10 x 50	3/4" x 10"	50 ft.	227 lbs.
SK60-24 x 12 x 50	3/4" x 12"	50 ft.	273 lbs.
SK60-32 x 3 x 50	1" x 3"	50 ft.	91 lbs.
SK60-32 x 6 x 50	1" x 6"	50 ft.	182 lbs.
SK60-32 x 8 x 50	1" x 8"	50 ft.	242 lbs.
SK60-32 x 10 x 50	1" x 10"	50 ft.	303 lbs.
SK60-32 x 12 x 50	1" x 12"	50 ft.	363 lbs.
SK60-48 x 10 x 50	1 1/2" x 10"	50 ft.	455 lbs.

48" Wide Skirtboard Rubber Sheet

SK60-08 x 48 x 50	1/4" x 48"	50 ft.	363 lbs.
SK60-12 x 48 x 50	3/8" x 48"	50 ft.	545 lbs.
SK60-16 x 48 x 50	1/2" x 48"	50 ft.	727 lbs.
SK60-24 x 48 x 50	3/4" x 48"	50 ft.	1090 lbs.

General Properties of 80 Durometer Skirtboard Rubber

- Excellent abrasion-resistance
- Excellent weather-resistance

80 DUROMETER SKIRTBOARD

PACKAGING: 50 Ft. Rolls

SPECIFICATIONS:

**Blended NR slit sheet,
Plate Finish:**

Style SK80: 80 Duro hardness (Shore Durometer A)

Polymer: Natural and Synthetic Rubber

Color: Black

Common Name: Skirtboard Rubber

ISO/ASTM Designation: NR

Tensile Strength: 600 PSI

Elongation: 200%

Applications:

Slit to width for Belt Wipers, Snow Plow Blades and Squeegee use.

Style	ASTM Specification (SI units)	Temp. Range	Durometer	Tensile Strength (PSI)	Elongation (%)	Finish
SK80	D 2000 M1AA 802	-22°F to +158°F	75 – 85	600	200%	Plate

ORDERING INFORMATION:

Item Number	Gauge x Width (Inches)	Avg. Length (Linear Ft./Roll)	Approx. Wt./Roll
SK80-16 x 4 x 50	1/2" x 4"	50 ft.	61 lbs.
SK80-16 x 6 x 50	1/2" x 6"	50 ft.	91 lbs.
SK80-16 x 8 x 50	1/2" x 8"	50 ft.	121 lbs.
SK80-24 x 6 x 50	3/4" x 6"	50 ft.	137 lbs.
SK80-24 x 8 x 50	3/4" x 8"	50 ft.	182 lbs.
SK80-32 x 6 x 50	1" x 6"	50 ft.	182 lbs.
SK80-32 x 8 x 50	1" x 8"	50 ft.	243 lbs.
SK80-32 x 10 x 50	1" x 10"	50 ft.	303 lbs.
SK80-32 x 12 x 50	1" x 12"	50 ft.	364 lbs.

CHANNEL RUBBER STRIP



SPECIFICATIONS:

Commercial grade black EPDM channel:

Hardness: 65 Duro hardness (Shore Durometer A)

Tensile Strength: 1,650 PSI

Elongation: 310%

STYLE RTCHNL
Round Top

STYLE THCHNL
Tapered Hex
Flat Top

STYLE HFTCHNL
Hex Flat Top

This channel rubber strip is ideal for use as a protective edge on shaker screens and a variety of other types of industrial equipment.

Standard Round Top Channel

Item Number	Size (Inches)	A	DIMENSION		
			B	C	D
RTCHNL-04X200	1/4"	.25	.81	.44	.56
RTCHNL-06X200	3/8"	.38	1.00	.50	.50
RTCHNL-08X100	1/2"	.50	1.25	.56	.63
RTCHNL-12X100	3/4"	.75	1.20	.63	1.40

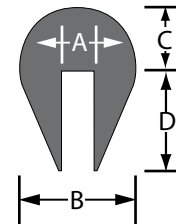

Tapered Hex-Flat Top Channel

Item Number	Size (Inches)	A	DIMENSION		
			B	C	D
THCHNL-04X200	1/4"	.25	.65	.38	.63
THCHNL-06X200	3/8"	.38	.85	.50	.63
THCHNL-08X100	1/2"	.50	1.20	.50	.69
THCHNL-12X100	3/4"	.75	1.45	.50	.75

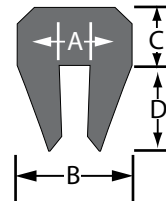

Hex-Flat Top Channel

Item Number	Size (Inches)	A	DIMENSION		
			B	C	D
HFTCHNL-04X200	1/4"	.25	.75	.31	.38
HFTCHNL-06X200	3/8"	.38	.88	.31	.44
HFTCHNL-08X100	1/2"	.50	1.00	.44	.50
HFTCHNL-12X100	3/4"	.75	1.25	.50	.63

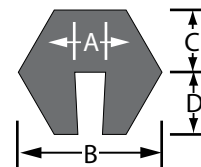

ORDERING INFORMATION:

Item Number	Channel Size (Inches)	Roll Length Linear Ft.	Approx. Wt./Roll
RTCHNL-04X200	1/4"	200	50 lbs.
RTCHNL-06X200	3/8"	200	70 lbs.
RTCHNL-08X100	1/2"	100	51 lbs.
RTCHNL-12X100	3/4"	100	70 lbs.
THCHNL-04X200	1/4"	200	44 lbs.
THCHNL-06X200	3/8"	200	64 lbs.
THCHNL-08X100	1/2"	100	48 lbs.
THCHNL-12x100	3/4"	100	62 lbs.
HFTCHNL-04X200	1/4"	200	24 lbs.

SHEET RUBBER GLOSSARY

Adhesion: (1) Basically, the adhering, clinging, bonding or sticking of two material surfaces to one another, such as rubber to rubber, rubber to glass, rubber to metal, rubber to wood, rubber to fabric, rubber to cord, rubber to wire, etc. (2) Refers to the strength of bond between cured rubber surfaces or cured rubber surface and a non-rubber surface.

Aging: To undergo changes to physical properties with age or lapse of time.

Aging, Air Oven: A means of accelerating the change in physical properties of rubber compounds by exposing them to the action of air at an elevated temperature.

Ambient Temperature: The environment temperature surrounding the object under consideration.

Blemish: A mark, deformity, or injury which impairs the appearance.

Blisters: A raised spot on the surface or a separation between layers usually forming a void or air-filled space in the vulcanized article. (See bubbles, sinks and voids.)

Bloom: A coating or efflorescence creating a discoloration or change in appearance of the surface of a rubber product caused by the migration of a liquid or solid to the surface. Examples: Sulfur Bloom, Wax Bloom. Not to be confused with dust on the surface from external sources.

Calendered: Continuously sheeted or plied up rubber compound or fabric that is frictioned or coated with rubber compound on a machine equipped with three or more heavy internally heated or cooled rolls revolving in opposite direction.

Checking: Short, shallow cracks on the surface, generally due to effect of destructive action of environmental conditions.

C. I. (Cloth-inserted): An abbreviation used to indicate a sheet of rubber containing one or more plies of cloth or duck, in which the cloth is completely covered with rubber.

Cloth Impression: Same as fabric impression.

Coating: A layer of material covering a surface.

Compression Set: The deformation which remains in rubber after it has been subjected to and released from a specific compressive stress

creep and stress relaxation properties of rubber.

Cracking: A sharp break or fissure in the surface. Generally due to excessive strain.

Crazing: A surface effect on rubber articles characterized by multitudinous minute cracks.

Cure: The act of vulcanization.

Curing Temperature: The temperature at which the rubber is vulcanized.

Diaphragm Sheet: Sheet (generally fabric-reinforced rubber) from which flat diaphragms may be cut.

Die Cut: Shaped articles punched from a sheet of rubber with a die.

Dielectric Strength: The measure of electric potential strength of a rubber product. Measure of its ability as an insulating compound to resist passage of a disruptive discharge produced by an electric stress. Measure as volts per mil of thickness.

Durometer: An instrument for measuring the hardness of rubber. Measures resistance to the penetration of an indenter point into the surface of the rubber.

Durometer Hardness: An arbitrary numerical value which measures the resistance to penetration of the indenter point of the durometer. Value may be taken immediately or after a very short specified time.

Elastomer: Macromolecular material that returns rapidly to approximately the initial dimensions and shape after substantial deformation by a weak stress and release of stress.

Elongation: Increase in length expressed numerically as a fraction or percentage of initial length.

Filler: (1) A material incorporated into a rubber compound to increase its bulk. (2) A compound built into a rubber product to increase its bulk and/or improve its appearance. (3) Sometimes erroneously used to mean "filling" in textiles.

Finish, Fabric: Same as impress, fabric.

Finish, Paper: Finish resulting from curing in contact with paper.

Finish Plate or Platen: Same as plate finish (sheet).

Foreign Material: Any extraneous matter such

SHEET RUBBER GLOSSARY

Gauge: (1) The measure of thickness of the individual elements making up a rubber product. (2) A device for measuring. (See thickness.)

Grain: The effect on a rubber compound due to processing it through a tubing machine, calender, or mill.

Hardness: Property or extent of being hard. Measured by extent of failure of the indenter point of any one of a number of standard hardness testing instruments to penetrate the product.

Homogeneity: Uniformity of composition throughout the material.

Homogeneous: Of uniform composition throughout.

Impression: Design formed during vulcanization in the surface of any rubber article by a method of transfer, such as fabric impression or molded impression.

Impression, Fabric: Impression formed during cure by fabric wrap.

Laminated: Built up from thinner layers.

Modulus: In the physical testing of rubber, it is the ratio of stress to strain; that is, the load in pounds per square inch or kilograms per square centimeter of initial cross sectional-area necessary to produce a stated percentage elongation. It is a measure of stiffness.

Non-blooming: The absence of bloom.

Oxidation: The reaction of oxygen on a rubber product, usually detected by a change in the appearance or feel of the surface, or by a change in physical properties

Ozone Cracking: Surface cracks, checks or crazing caused by exposure to an atmosphere containing ozone. (See also ozone resistant.)

Ozone Resistant: Withstands the deteriorating effects of ozone, generally cracking.

Plate Finish (Sheet): A commercially smooth surface, the usual result of vulcanization between press plates (platens).

Ply: (1) A layer of rubberized fabric. (2) A layer consisting of multiple strands of cord or wire close spaced. (3) A single yarn in a composite yarn. (4) Used in processing as a layer of unvulcanized rubber compound.

condensation polymerization. The units may be the same or different. There are copolymers, di-polymers, tri or ter polymers, quadri-polymers, high polymers, etc. Natural rubber is a polymer of Isoprene.

Press Length: The length of a product which can be vulcanized at one time in a press, limited to the length measurement of the press.

Random Length: A unit of material which does not fall into any current classification for standard length.

Relative Humidity: The ratio of the quantity of water vapor actually present in the atmosphere to the greatest amount possible at the given temperature.

Roll: Sheet rubber and gasket material of a uniform width rolled up on itself from which gaskets and other products of lesser dimensions and various shapes may be cut.

Rubber: A material that is capable of recovering from large deformations quickly and forcibly, and can be, or already is, modified to a state in which it is essentially insoluble (but can swell) in boiling solvent, such as benzene, methyl ethyl ketone, and ethanol-toluene azeotrope.

Sinks: A collapsed blister or bubble leaving a depression in the product.

Slab: Thick sheet, generally laminated.

Specific Gravity: The ratio of the weight of a given substance to the weight of an equal volume of water at a specified temperature.

Tacky (Rubber Surface): Tending to adhere.

Tensile Strength: The maximum tensile stress applied during stretching a specimen to rupture.

Viscosity: A manifestation of internal friction opposed to mobility. The property of fluids and plastic solids by which they resist an instantaneous change of shape, i.e., resistant to flow.

Volume Swell: Increase in physical size caused by the swelling action of a liquid.

Vulcanization: Act or process of treating an elastomer or compound of same to improve its useful properties, usually accomplished by application of heat.

Warp: The yarns that run lengthwise in a woven fabric.

Weft: The crosswise threads in a fabric; filling

General properties of common polymers used in sheet rubber

	Neoprene	Nitrile	EPDM	SBR	CI	Pure Gum	Silicone	Viton	Hypalon
Heat Aging	Good	Good	Excellent	Good	Good	Good	Excellent	Excellent	Good
Abrasion Resistance	Excellent	Excellent	Very Good	Good	Good	Excellent	Poor	Fair	Fair
Compression Set	Fair	Fair	Fair	Good	Good	Good	Fair	Good	Good
Resilience	Excellent	Good	Good	Good	Good	Outstanding	Fair	Fair	Fair
Tear	Good	Good	Good	Fair	Good	Good	Good	Fair	Fair
Flame Resistance	Excellent	Poor	Very Poor	Very Poor	Very Poor	Very Poor	Fair	Good	Good
Weathering	Very Good	Fair	Excellent	Fair	Fair	Fair	Good	Excellent	Excellent
Ozone Resistance	Very Good	Very Poor	Good	Fair	Fair	Poor	Good	Excellent	Excellent
Gas Permeability Resistance	Good	Good	Good	Good	Good	Good	Poor	Poor	Poor
Oil Resistance	Good	Very Good	Very Poor	Poor	Poor	Very Poor	Fair	Good	Fair
Gas Resistance	Good	Excellent	Very Poor	Poor	Poor	Very Poor	Poor	Poor	Poor
Acid Resistance	Good	Good	Good	Fair	Fair	Good	Poor	Good	Good
Alkali Resistance	Good	Good	Good	Fair	Fair	Good	Poor	Good	Good

TAKE NOTE!

The general properties shown in the chart above are not intended to be used to make final choices for a specific application. Exposure to heat, sunlight, chemicals, ozone and oils, as well as pressure, tension, binding, stretching and folding, will affect the performance of a rubber product.

Suitability must be determined by a qualified person. See Cautionary Statement on the next page.

Sheet Rubber Tolerances

(Tolerances conform to RMA standards, Durometer \pm 5 points.)

Thickness	Tolerance	Thickness	Tolerance
1/32" but not including 1/16"	\pm .012"	9/16" but not including 3/4"	\pm .062"
1/16" but not including 1/8"	\pm .016"	3/4" but not including 1"	\pm .094"
1/8" but not including 3/16"	\pm .020"	1" and Over.....	\pm 10%
3/16" but not including 3/8"	\pm .031"	Width	Tolerance
3/8" but not including 9/16"	\pm .047"	36" and over	\pm 1.00"