

S63PB Swivel Male Branch Tee BSPT

PART NO.	TUBE SIZE	BSPT	C HEX	C4 HEX	L	M	N
S63PB4-1/8	4	1/8	10	10	36	18	26.5
S63PB4-1/4	4	1/4	10	14	36	18	30.0
S63PB6-1/8	6	1/8	12	11	40	20	28.0
S63PB6-1/4	6	1/4	12	14	40	20	31.0
S63PB8-1/8	8	1/8	14	14	44	22	30.0
S63PB8-1/4	8	1/4	14	14	44	22	33.0
S63PB8-3/8	8	3/8	14	17	44	22	34.5
S63PB10-1/4	10	1/4	17	17	56	28	40.0
S63PB10-3/8	10	3/8	17	17	56	28	39.0
S63PB12-1/4	12	1/4	22	19	60	30	42.0
S63PB12-3/8	12	3/8	22	19	60	30	41.0
S63PB12-1/2	12	1/2	22	22	60	30	44.5
S63PB14-3/8	14	3/8	25	22	68	34	46.0
S63PB14-1/2	14	1/2	25	22	68	34	48.5

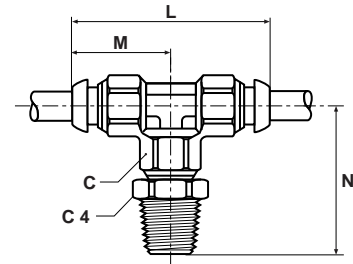

S64PB Swivel Male Branch Tee BSPP

PART NO.	TUBE SIZE	BSPP	C HEX	C4 HEX	L	M	N
S64PB4-1/8	4	1/8	10	14	36	18	26.5
S64PB4-1/4	4	1/4	10	19	36	18	31.5
S64PB6-1/8	6	1/8	12	14	40	20	30.0
S64PB6-1/4	6	1/4	12	19	40	20	33.0
S64PB8-1/8	8	1/8	14	14	44	22	30.0
S64PB8-1/4	8	1/4	14	19	44	22	35.0
S64PB8-3/8	8	3/8	14	22	44	22	36.0
S64PB10-1/4	10	1/4	17	19	56	28	39.0
S64PB10-3/8	10	3/8	17	22	56	28	40.0
S64PB12-1/4	12	1/4	22	19	60	30	41.0
S64PB12-3/8	12	3/8	22	22	60	30	42.0
S64PB14-3/8	14	3/8	25	22	68	34	46.0
S64PB14-1/2	14	1/2	25	27	68	34	50.5

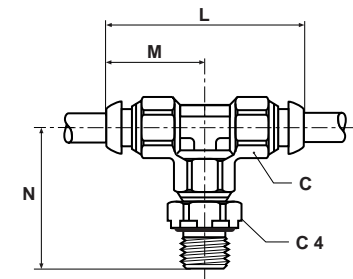

S68PB Adjustable Male Branch Tee Metric Straight Thread

PART NO.	TUBE SIZE	MM THREAD	C HEX	C4 HEX	L	M	N
S68PB4M3	4	M3x0.5	10	10	36	18	23.0
S68PB4M5	4	M5x0.8	10	10	36	18	24.5
S68PB6M5	6	M5x0.8	12	11	40	20	25.5

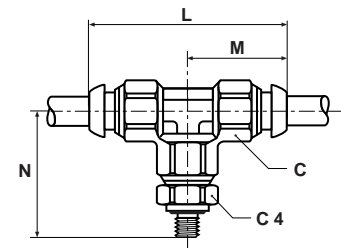

CORPB Single Banjo Body Only

PART NO.	TUBE SIZE	PART N° SINGLE BOLT	PART N° STACKING BOLT	M	X	Y
CORPB4-5	4	SC8UM5-4	SC8UDM5-4	19.0	10	10
CORPB4-10	4	SC4U1/8-4	SC4UD1/8-4	22.5	14	14
CORPB6-10	6	SC4U1/8-4	SC4UD1/8-4	23.0	14	14
CORPB6-13	6	SC4U1/4-6	SC4UD1/4-6	24.5	14	17
CORPB8-10	8	SC4U1/8-4	SC4UD1/8-4	24.0	14	14
CORPB8-13	8	SC4U1/4-6	SC4UD1/4-6	25.5	14	17
CORPB10-17	10	SC4U3/8-10	SC4UD3/8-10	32.0	17	22

