

PIPE

BRASS FITTINGS

BRASS

STREET TEE

SAE# 130424

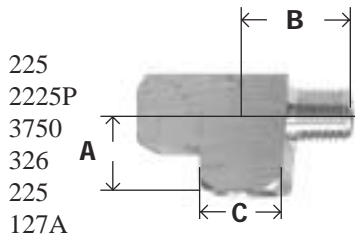

Part #	Thread size NPTF	A	B	C	Weight per piece. Lbs	List Price
28-245	1/8"	0.55	0.66	0.56	0.08	2.46
28-246	1/4"	0.78	0.91	0.68	0.17	4.10
28-247	3/8"	0.84	0.97	0.81	0.22	4.36
28-248	1/2"	1.09	1.25	1.00	0.40	8.61
28-249	3/4"	1.16	1.39	1.25	0.60	21.32

FORGED STREET TEE

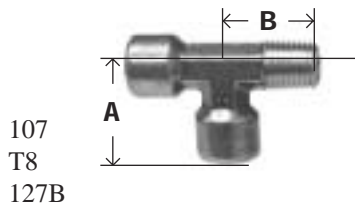

Part #	Thread size NPTF	A	B	Body Width	Weight per piece. Lbs	List Price
28-253	1/8"	0.56	0.75	0.50	0.05	3.36
28-254	1/4"	1.03	0.11	0.46	0.13	3.79
28-255	3/8"	1.19	1.09	0.68	0.24	9.08
28-256	1/2"	1.52	1.40	0.88	0.45	20.68
28-257	3/4"	1.34	1.73	1.25	0.65	49.67

EXTENDER ADAPTER

SAE# 130139

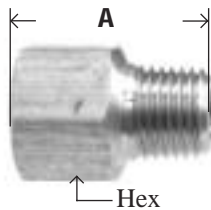

Part #	Thread size NPTF FxM	A	Hex	Weight per piece. Lbs	List Price
28-190L	1/8" x 1/8"	0.83	0.50	0.03	1.33
28-190	1/8" x 1/8"	0.88	0.56	0.04	1.07
28-191L	1/4" x 1/8"	0.94	0.62	0.04	1.30
28-191	1/4" x 1/8"	1.06	0.75	0.07	1.97
28-192L	1/4" x 1/4"	1.00	0.62	0.04	1.32
28-192	1/4" x 1/4"	1.25	0.75	0.07	3.29
28-198	3/8" x 1/8"	1.00	0.81	0.06	3.60
28-193L	3/8" x 1/4"	1.12	0.81	0.08	1.48
28-193	3/8" x 1/4"	1.25	0.87	0.09	2.62
28-194L	3/8" x 3/8"	1.24	0.81	0.10	2.58
28-194	3/8" x 3/8"	1.25	0.87	0.11	3.18
28-199	1/2" x 1/4"	1.46	1.06	0.08	3.83
28-195L	1/2" x 3/8"	1.19	0.93	0.09	3.24
28-195	1/2" x 3/8"	1.47	1.06	0.18	4.38
28-196	1/2" x 1/2"	1.66	1.06	0.12	4.66
28-207	3/4" x 3/8"	1.59	1.25	0.26	15.94
28-208	3/4" x 1/2"	1.69	1.37	0.14	4.70
28-209	3/4" x 3/4"	1.69	1.37	0.34	15.07

PIPE SWIVEL ADAPTER

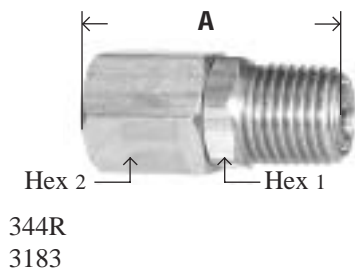

Part #	Thread size NPTF FxM	A	Hex 1	Hex 2	Weight per piece. Lbs	List Price
28-425	1/4"	1.34	0.56	0.62	0.06	12.25
28-426	3/8"	1.36	0.68	0.75	0.08	27.93

SWIVEL FITTING

- 1/4" Basic size
- Industrial Interchange Plug
- 360° Turning
- Swivels



Male NPT x Female NPT

Part #	Size	List Price
320-061	1/4	16.42

MIDLAND METAL

GOODYEAR RUBBER PRODUCTS INC.

Call Toll Free: 1-866-711-4673

WebSales@GoodyearRubberProducts.com

We Ship World Wide