

TECHNICAL AND DIMENSIONAL INFORMATION*

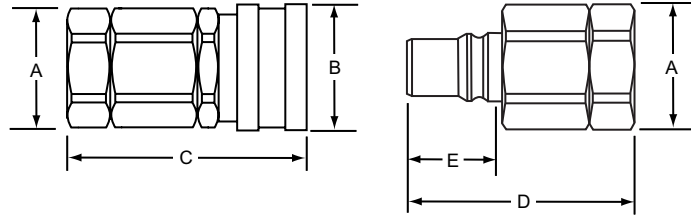

DIMENSIONS

Size	A (HEX)		B		C		D		E	
	in	mm	in	mm	in	mm	in	mm	in	mm
1/4"	.88	22.35	1.19	30.23	2.01	51.05	1.80	45.72	.80	20.30
1/2" x 3/8"	1.19	30.23	1.38	35.05	2.41	61.21	2.30	58.42	.97	24.64
1/2"	1.19	30.23	1.38	35.05	2.50	63.50	2.38	60.45	.97	24.64

*NOTE: Dimensions and outlines are the same for both valved and plain units

FLOW CHART - VALVED AND VALVED

