

**Prestomatic<sup>†</sup> Retaining Ring Bulkhead Unions**

Prestomatic<sup>†</sup> retaining ring bulkhead unions feature a unique design that provides the user with an economical method to install and assemble a union connection through a bulkhead.

The retaining ring bulkhead unions feature a smaller envelope size than standard bulkhead union connectors and do not require a wrench to mount or assemble in cramped areas.

The external seal feature provides a moisture barrier and can also prevent external contamination from entering into an enclosed area.

To install, simply support the bulkhead union from behind and apply the external seal. Then push the external retainer against the external seal with an assembly tool and you have a reliable bulkhead connection in a confined area.

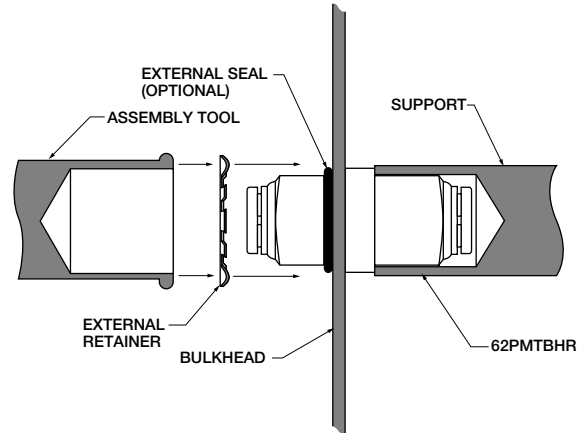

**Retaining Ring Bulkhead 62PMTBHR**

PART NO.	TUBE SIZE	O.D.	REC. HOLE SIZE	L	P MAX	A DIA
62PMTBHR-4	1/4	.500	.512	1.53	.26	.625
62PMTBHR-6	3/8	.750	.762	1.92	.36	.875
62PMTBHR-8	1/2	.875	.887	2.15	.43	1.000
62PMTBHR-10	5/8	1.000	1.012	2.54	.62	1.250

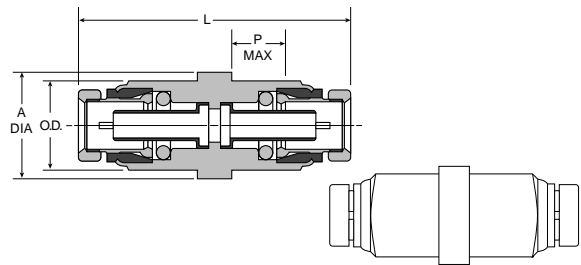

**External Retainer ERHD\***

PART NUMBER	TUBE SIZE	BULKHEAD UNION O.D.	A DIA	W
ERHD-50	1/4	.500	.83	.05
ERHD-75	3/8	.750	1.08	.05
ERHD-87	1/2	.875	1.20	.05
ERHD-100	5/8	1.000	1.33	.05

\*Material Carbon Spring Steel

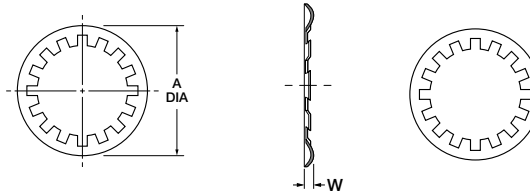

**External Seal ES\***

PART NUMBER	TUBE SIZE	BULKHEAD UNION O.D.	I.D.	W
ES-50	1/4	.500	.489	.07
ES-75	3/8	.750	.739	.07
ES-87	1/2	.875	.864	.07
ES-100	5/8	1.000	.989	.07

\*Material is Nitrite (Buna N), 70 Durometer

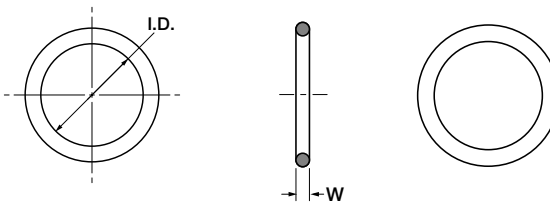

**Union 62PM**

PART NO.	TUBE SIZE	L	O.D.
62PM-2	1/8	1.60	0.406
62PM-5/32	5/32	1.60	0.406
62PM-3	3/16	1.35	0.440

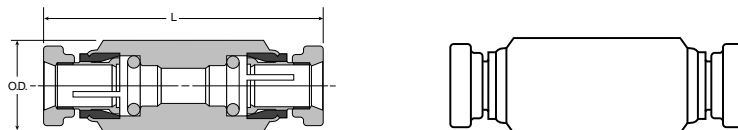

† U.S. Patent No. 5,683,120