

F8PB Male Connector Metric Straight Thread

PART NO.	TUBE SIZE	MM THREAD	C HEX	L
F8PB4M5	4	M5X0.8	12	25.5
F8PB4M10	4	M10X1	14	24.0
F8PB6M5	6	M5X0.8	14	26.0
F8PB6M10	6	M10X1	14	28.0
F8PB6M12	6	M12X1.5	17	30.0
F8PB8M12	8	M12X1.5	17	30.0
F8PB8M16	8	M16X1.5	22	28.0
F8PB8M22	8	M22X1.5	27	30.0

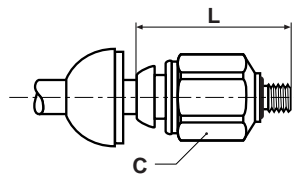

G4PB Female Connector BSPP

PART NO.	TUBE SIZE	BSPP THREAD	C HEX	L
G4PB4-1/8	4	1/8	14	26.0
G4PB6-1/8	6	1/8	14	27.5
G4PB6-1/4	4	1/4	17	33.0
G4PB8-1/8	8	1/8	17	29.0
G4PB8-1/4	8	1/4	17	33.0

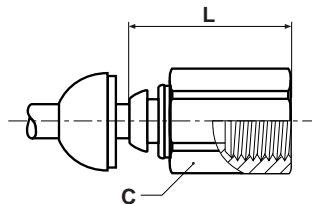

WG4PB Bulkhead Union Female BSPP

PART NUMBER	TUBE SIZE	BSPP	B2	C1 HEX	C2 HEX	J	L	W
WG4PB4-1/8	4	G1/8	M11x0.75	14	14	8	25.0	6
WG4PB6-1/8	6	G1/8	M13x1	17	17	8	25.0	6
WG4PB6-1/4	6	G1/4	M13x1	17	19	12	29.5	6
WG4PB8-1/8	8	G1/8	M15x1.25	19	17	8	25.0	6
WG4PB8-1/4	8	G1/4	M15x1.25	19	19	12	30.0	6
WG4PB10-3/8	10	G3/8	M18x1	22	22	12	34.0	8
WG4PB12-3/8	12	G3/8	M23x1.5	27	24	12	35.0	10
WG4PB12-1/2	12	G1/2	M23x1.5	27	27	14	40.0	10

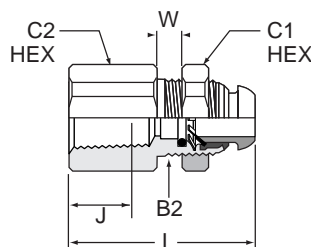

HPK Equal Union

PART NO.	TUBE SIZE	L
HPK4	4	33.5
HPK6	6	37.0
HPK8	8	39.0
HPK10	10	48.0
HPK12	12	49.0
HPK14	14	54.0

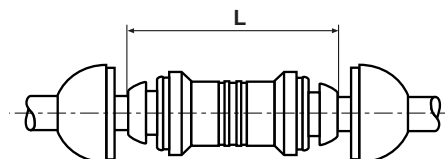

HPK Unequal Union

PART NO.	TUBE 1 SIZE	TUBE 2 SIZE	L
HPK6-4	6	4	36.0
HPK8-4	8	4	38.0
HPK8-6	8	6	39.0
HPK10-6	10	6	47.0
HPK10-8	10	8	47.0
HPK12-10	12	10	49.5

