

Female Bulkhead 66MLBH

PART NO.	TUBE SIZE	PIPE THREAD NPTF	B THREAD	C HEX	P MAX	L	FLOW DIA. D.
66MLBH-2-4	1/8	1/4	3/8-24	11/16	.31	1.22	.093
66MLBH-5/32-2	5/32	1/8	7/16-24	9/16	.36	1.07	.110
66MLBH-5/32-4	5/32	1/4	7/16-24	11/16	.36	1.29	.110
66MLBH-4-2	1/4	1/8	1/2-24	9/16	.36	1.06	.190
66MLBH-4-4	1/4	1/4	1/2-24	11/16	.36	1.25	.190
66MLBH-6-6	3/8	3/8	3/4-16	7/8	.36	1.34	.312
66MLBH-8-6	1/2	3/8	7/8-14	1	.36	1.41	.440
66MLBH-8-8	1/2	1/2	7/8-14	1	.36	1.64	.440

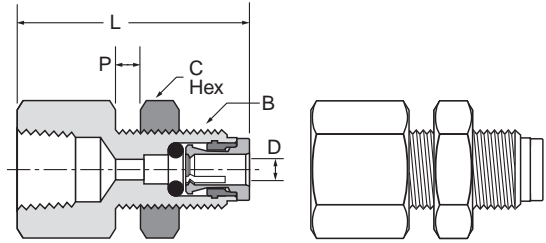

Microlok Male Connector W68ML

PART NO.	TUBE SIZE	PIPE THREAD	C HEX	ASSM. HT. N	M	FLOW DIA. D
W68ML-2-1	1/8	1/16	3/8	.50	.49	.094
W68ML-2-2	1/8	1/8	7/16	.48	.49	.094
W68ML-2-4	1/8	1/4	9/16	.39	.49	.094
68ML-2-0	1/8	10-32	3/8	.59	.49	.078
W68ML-5/32-1	5/32	1/16	7/16	.53	.49	.094
W68ML-5/32-2	5/32	1/8	7/16	.33	.49	.110
W68ML-5/32-4	5/32	1/4	5/8	.45	.49	.110
68ML-5/32-0	5/32	10-32	7/16	.60	.49	.078
W68ML-4-1	1/4	1/16	7/16	.68	.52	.141
W68ML-4-2	1/4	1/8	1/2	.57	.52	.156
W68ML-4-4	1/4	1/4	5/8	.46	.52	.156
W68ML-4-6	1/4	3/8	11/16	.52	.52	.200
68ML-4-0	1/4	10-32	7/16	.60	.52	.078
W68ML-6-2	3/8	1/8	5/8	.87	.80	.220
W68ML-6-4	3/8	1/4	5/8	.83	.80	.314
W68ML-6-6	3/8	3/8	11/16	.64	.80	.314
W68ML-6-8	3/8	1/2	7/8	.72	.80	.314
W68ML-8-4	1/2	1/4	3/4	1.07	.84	.314
W68ML-8-6	1/2	3/8	3/4	.84	.84	.440
W68ML-8-8	1/2	1/2	7/8	.75	.84	.440

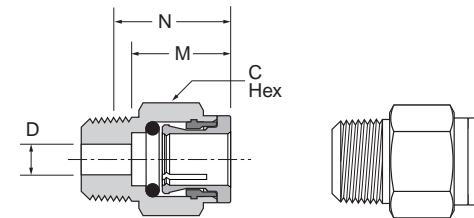
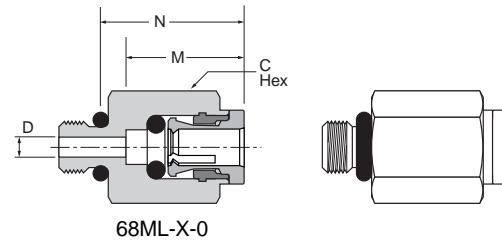

Microlok Round Body Male Connector W68MLR

PART NO.	TUBE SIZE	PIPE THREAD	BODY DIA. H	INTERNAL HEX	ASSM. HT. N	M	FLOW DIA. D
68MLR-2-0	1/8	10-32	.34	-	.54	.49	.078
W68MLR-5/32-1	5/32	1/16	.38	1/8	.54	.49	.126
W68MLR-5/32-2	5/32	1/8	.43	1/8	.56	.49	.126
68MLR-5/32-0	5/32	10-32	.38	-	.63	.49	.078
W68MLR-4-1	1/4	1/16	.47	5/32	.68	.52	.156
W68MLR-4-2	1/4	1/8	.47	3/16	.59	.52	.188
W68MLR-4-4	1/4	1/4	.59	3/16	.51	.52	.188
68MLR-4-0	1/4	10-32	.47	-	.68	.52	.094
W68MLR-6-2	3/8	1/8	.63	3/16	.97	.80	.191
W68MLR-6-4	3/8	1/4	.63	1/4	.83	.80	.254
W68MLR-6-6	3/8	3/8	.69	1/4	.64	.80	.254
WMLR-8-4	1/2	1/4	.75	5/16	1.07	.84	.316
W68MLR-8-6	1/2	3/8	.75	3/8	.89	.84	.379
W68MLR-8-8	1/2	1/2	.88	3/8	.75	.84	.379

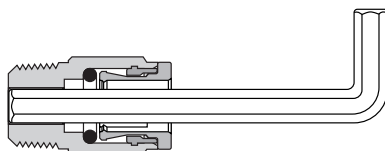
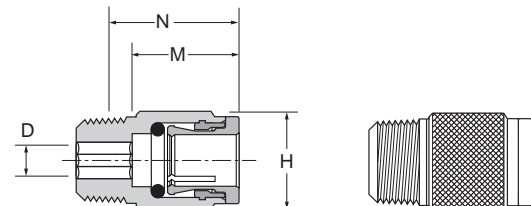
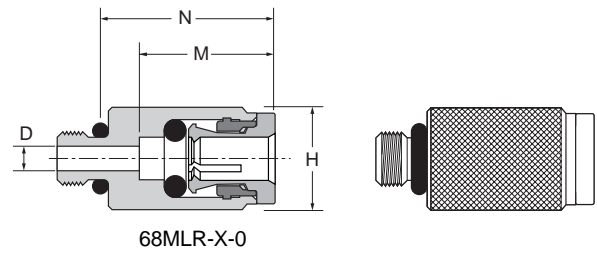

5/32" and larger straight Microlok round body Male Connectors with Pipe Threads have an internal hex for the use of an Allen Key to allow the fitting to be mounted in any position. This also permits close porting not possible with a standard wrench.