

FORGED BRASS BALL VALVE - STANDARD PORT

1/2" Gas Approved



CSA AGA 3.88 5 PSIG

ISO 9002 Manufacturer FEATURES

- 400 PSI non-shock cold water, gas, oil
- 150 PSI saturated steam (WSP)
 - Solid chrome plated brass ball
 - Threaded ends to ANSI B1.20.1
 - Each valve individually tested
 - Hard chromium plated solid ball
 - Bottom entry, blow-out proof stem
 - Double stem packing, Teflon seats.

VALVES



Yellow Handle

FIP x FIP

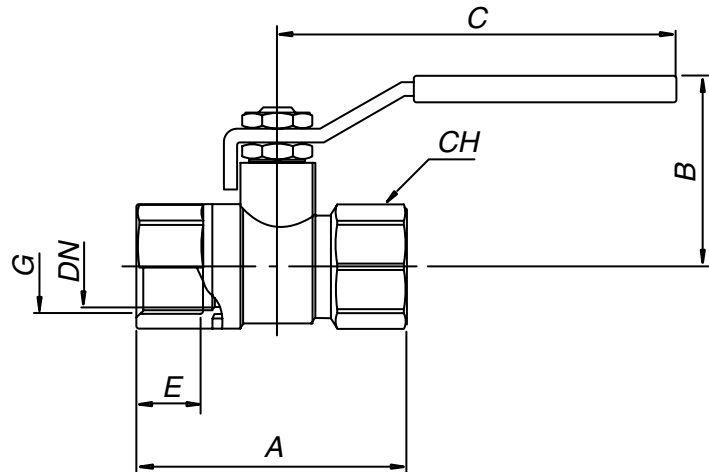

FORGED BRASS BALL VALVE IPS SCREWED ENDS

Part#	Size	Dimension Inches						Box	Case	List
	G	DN	A	B	C	E	CH			
940-241	1/2	0.47	2.26	1.51	3.27	0.61	0.98	20	200	19.27
940-242	3/4	0.59	2.50	1.59	3.27	0.63	1.22	14	140	25.25
940-243	1	0.78	2.87	1.88	3.74	0.75	1.49	6	60	40.71
940-244	1-1/4	0.98	3.46	2.08	4.61	0.77	1.89	4	40	66.12
940-245	1-1/2	1.26	3.52	2.45	4.61	0.77	2.13	2	20	99.22
940-246	2	1.57	4.05	2.65	4.61	0.79	2.64	1	10	143.05

See additional handle options on page 173

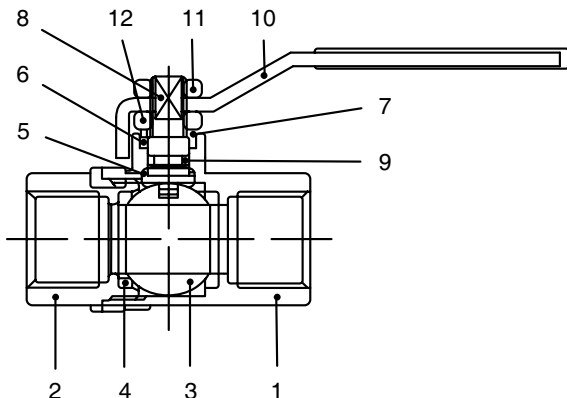

POS	Components	Materials	N
1	Body	Forged Brass	1
2	End Connection	Forged Brass	1
3	Ball	CP Brass	1
4	Ball Stems	P.T.F.E.	2
5	Stem Antif. Seat	P.T.F.E.	1
6	Stem Seat	P.T.F.E.	1
7	Brass Ring	Brass	1
8	Stem	Brass	1
9	O-Ring	NBR 80	1
10	Handle	Steel	1
11	Nut	Steel	1
12	Nut	Brass	1

