

FULL PORT 600WOG FORGED BRASS BALL VALVE



ISO 9002 Manufacturer FEATURES

600 PSI non-shock cold water, gas, oil
- 150 PSI saturated steam

CSA AGA 3.88 5 PSIG IAMPO IGC 157 - 2004b

- **SOLID CHROME PLATED BRASS BALL**
- Suitable for full range of liquids and gases
- Minimal pressure drop due to large full size ports
- Bottom loaded, pressure retaining stem
- Pressure rated at 600psi (42 bars) WOG (non-shock) and 150 WSP (10.34 bars) saturated steam. Virgin TFE stem packing seal, thrust washer and seats
- Yellow vinyl insulator on heavy duty plated carbon steel handles
- Fast 1/4 turn open or close operation
- Low operating torque
- Flow can go both directions

- Adjustable stem packing gland
- Maximum operating temperature: 248°F (120° C) at 600 PSI
- Minimum operating temperature: -20°F (-40°C)
- Each valve individually tested
- Forged Brass - for more strength
- Threaded ends to ANSI B1.20.1
- Hard chromium plated solid ball
- Bottom entry, blow-out proof stem
- Deeper threads - for better connections

VALVES



Made in Italy

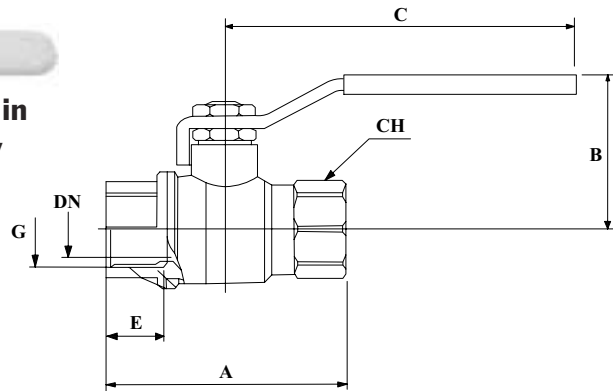

Female x Female

| Part# | Size | Dimension Inches | | | | | | Box | Case | List |
|---------|--------|------------------|------|------|------|------|------|-----|------|--------|
| | | G | DN | A | B | C | E | | | |
| 943-500 | 1/4" | .31 | 1.96 | 1.57 | 3.43 | .43 | .74 | 24 | 240 | 11.66 |
| 943-501 | 3/8" | .39 | 1.96 | 1.57 | 3.43 | .43 | .86 | 24 | 240 | 11.77 |
| 943-502 | 1/2" | .59 | 2.28 | 1.77 | 3.35 | .61 | .94 | 20 | 200 | 14.32 |
| 943-503 | 3/4" | .78 | 2.44 | 1.89 | 3.35 | .64 | 1.22 | 14 | 140 | 20.81 |
| 943-504 | 1" | .98 | 3.03 | 2.20 | 4.61 | .75 | 1.50 | 6 | 60 | 32.30 |
| 943-505 | 1-1/4" | 1.26 | 3.46 | 2.36 | 4.61 | .77 | 1.89 | 4 | 40 | 50.34 |
| 943-506 | 1-1/2" | 1.57 | 3.94 | 3.15 | 6.30 | .77 | 2.12 | 2 | 20 | 82.86 |
| 943-507 | 2" | 1.97 | 4.45 | 3.15 | 6.30 | .79 | 2.63 | 2 | 20 | 121.21 |
| 942-508 | 2-1/2" | 2.48 | 5.94 | 4.17 | 7.48 | 1.06 | 3.30 | 2 | 12 | 239.59 |
| 943-509 | 3" | 2.99 | 6.85 | 5.47 | 9.84 | 1.14 | 3.89 | 6 | 6 | 368.41 |
| 943-510 | 4" | 3.54 | 7.67 | 5.88 | 9.84 | 1.50 | 4.80 | 3 | 3 | 602.29 |

See additional handle options on page ---

- Nickel plated body available upon special request.
- Optional stainless steel parts available upon special request.

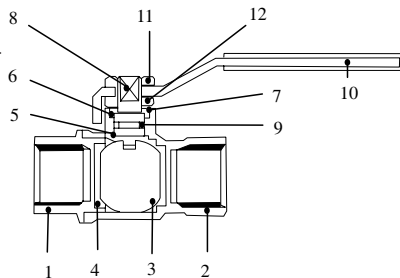

| POS | Components | Materials | N |
|-----|------------------|--------------|---|
| 1 | Body | Forged Brass | 1 |
| 2 | End Connection | Forged Brass | 1 |
| 3 | Ball | CP Brass | 1 |
| 4 | Ball Stems | P.T.F.E. | 2 |
| 5 | Stem Antif. Seat | P.T.F.E. | 1 |
| 6 | Stem Seat | P.T.F.E. | 1 |
| 7 | Brass Ring | Brass | 1 |
| 8 | Stem | Brass | 1 |
| 9 | O-Ring | NBR 80 | 1 |
| 10 | Handle | Steel | 1 |
| 11 | Nut | Steel | 1 |
| 12 | Nut | Brass | 1 |

