

FULL PORT 600WOG FORGED BRASS BALL VALVE

- 600 PSI non-shock cold water, gas, oil
- 150 PSI saturated steam (WSP)
- IAMPO IGC 157 - 2004b

**ISO 9002 Manufacturer
FEATURES**

- Minimal pressure drop due to large full size ports.
- Bottom loaded, pressure retaining stem.
- Pressure rated at 600psi (42 bars) WOG (non-shock) and 150psi (10.34 bars) saturated steam. Virgin TFE stem packing seal, thrust washer and seats.
- Vinyl insulator on heavy duty plated carbon steel handles.
- Fast 1/4 turn open or close operation
- Low operating torque
- Adjustable stem packing gland.

- Maximum operating temperature: 248°F (120° C) at 600 psi.
- Minimum operating temperature: -20°F (-40°C)
- Each valve individually tested.
- Forged Brass - for more strength.
- Tube ends to ANSI B16.22.
- Hard chromium plated solid ball.
- Bottom entry, blow-out proof stem.
- Use with ASTM B88 copper water tubing.



SWT x SWT

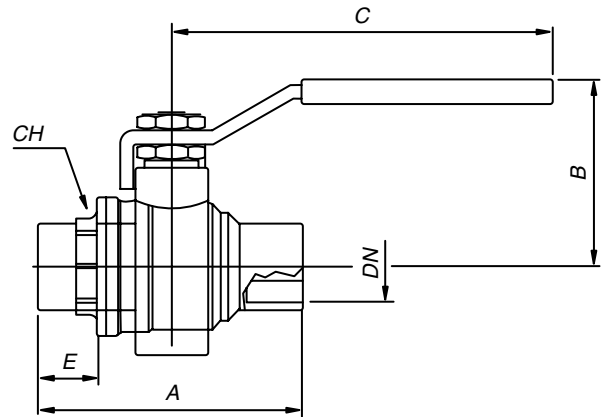

Part#	Size SWT	Dimension Inches						Box	Case	List
		DN	A	B	C	E	CH			
943-612	1/2" SWT	0.59	2.28	1.91	3.74	0.61	0.96	15	120	8.63
943-613	3/4" SWT	0.78	2.52	2.03	4.41	0.62	1.20	10	90	11.50
943-614	1" SWT	0.98	3.01	2.44	4.41	0.75	1.48	6	60	25.76
943-615	1-1/4" SWT	1.26	3.37	2.56	4.98	0.77	1.63	6	36	24.73
943-616	1-1/2" SWT	1.57	3.74	3.01	5.79	0.77	2.10	4	24	65.04
943-617	2" SWT	1.97	4.17	3.37	6.10	0.78	2.62	2	16	86.62

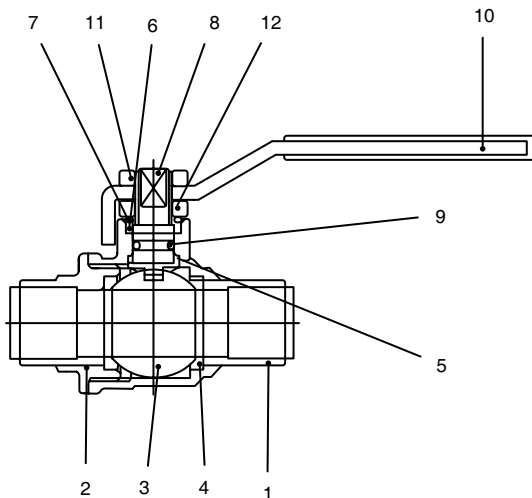

POS	Components	Materials	N
1	Body	Forged Brass	1
2	End Connection	Forged Brass	1
3	Ball	CP Brass	1
4	Ball Seats	P.T.F.E.	2
5	Stem	Brass	1
6	O-Ring	NBR 80	1
7	Handle	Steel	1
8	Nut	UNI 5771 Steel	1
9	Stem Seat	P.T.F.E.	1
10	Brass Ring	Brass	1
11	Stem Seat	P.T.F.E.	1
12	Nut	Brass	1

VALVES

