

TWO PART CLAMPS

This unique two part clamp is adaptable to a variety of latching or locking applications where repeated opening and closing is necessary. Holes in the end of each part allow for permanent installation of clamp with rivets or screws.

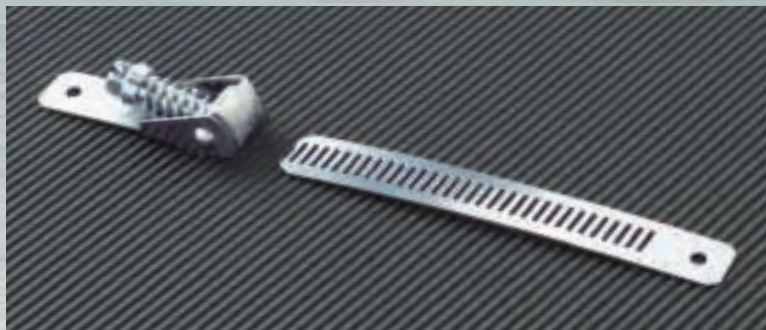

Ideal 58 Series / Tridon 502 Series

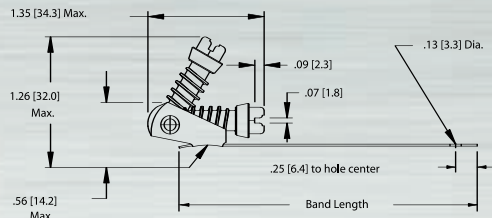

HOUSING					
Ideal Part No.	Tridon Part No.	Band Length		Hole Diameter	
58 (2-pc) Series	502 Series	Inches	mm	Inches	mm
5823	502-002	1.86	47.2	0.13	3.3
5825	502-003	1.50	38.1	0.13	3.3
5829	502-004	3.72	94.5	0.13	3.3
5830	502-005	3.63	92.1	0.25	6.4

Ideal 62 Series / Tridon 503 Series

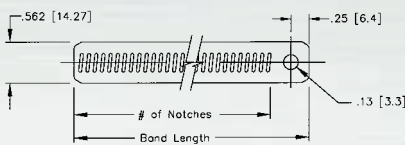

Measurements in illustrations are in inches (millimeters)

BAND					
Ideal Part No.	Tridon Part No.	Band Length		Hole Diameter	
62 (2-pc) Series	503 Series	Inches	mm	Inches	mm
62647	503-002	4.81	122.2	0.13	3.3
62648	503-003	3.88	98.4	0.13	3.3
62649	503-004	6.50	165.1	0.13	3.3
62650	503-005	4.75	120.7	0.13	6.4
62654	503-006	10.06	255.6	0.13	3.3
62655	503-007	2.00	50.8	0.13	3.3
62656	503-008	6.00	152.4	0.25	6.4

Screw: 5/16" hex-head. Plated carbon steel.
Band and housing: 1/2" wide stainless steel.

Also available in all zinc-plated, carbon steel. Contact Ideal for details.

NYLON CABLE TIES

One piece 6/6 nylon for tying, bundling and positioning in industrial, PHAC, automotive and marine applications. Corrosion and fungus-resistant. Available in diameters from 1/16" to 13".

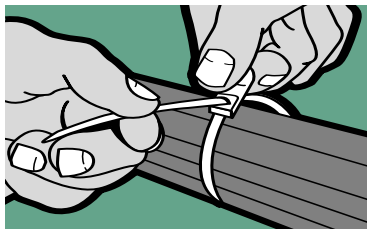

Ideal 665 Series (Tridon N/A)

Self-locking.

- Install easily with or without tools
- Corrosion and fungus resistant
- Tapered tips slip easily under and around cables
- Flexible nylon conforms readily to most shapes
- Uniform serrations along the tie permit easy "pull-through" right down to the bundle – ready for final tensioning and cut off for a neat, tight harness

NYLON CABLE TIES - 665 SERIES				
Ideal Part No.	CLAMPING RANGE		Min. Tensile Strength	Applicable Mil. Spec.
	English (in.) Min. Dia.	Max. Dia.		
665				
66501	1/16	1	18 lbs.	MS3367-4
66502	1/16	1 1/4	30 lbs.	MS3367-5
66505	1/16	1 3/4	50 lbs.	MS3367-1
66506	1/16	3	50 lbs.	MS3367-7
66507	1/16	4	50 lbs.	MS3367-2
66509	3/16	4	120 lbs.	MS3367-3
66510	3/16	6	175 lbs.	MS3367-3
66511	3/16	9	175 lbs.	MS3367-6
66512	3/16	13	175 lbs.	None

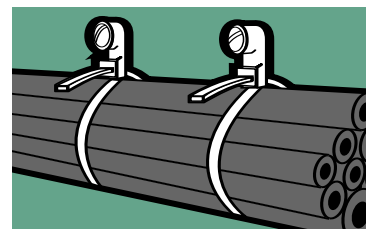

Ideal 666 Series (Tridon N/A)

Self-locking with mounting heads for quick, simple cable mounting.

- Once ties are installed, simply pass a screw, bolt or rivet through mounting hole to secure harness in place
- Bundling and mounting is done with one unit

NYLON CABLE TIES - 666 SERIES				
Ideal Part No.	CLAMPING RANGE		Min. Tensile Strength	Hole Size
	English (in.) Min. Dia.	Max. Dia.		
666				
66604	1/16	1 3/4	50 lbs.	0.208
66605	1/16	4	50 lbs.	0.208
66606	3/16	4	120 lbs.	0.250