

GENERAL PURPOSE

SUPERIOR QUALITY AND CLAMPING EXPERTISE

Ideal is a leading manufacturer and supplier of clamping and joint sealing products worldwide. With over 90 years of experience in clamping technology, we've employed advanced materials and cutting-edge technology to construct innovative, superior quality clamping and sealing products for both simple and extraordinary uses.

Setting the industry standard for fastener engineering expertise, we offer a broad range of Ideal and Tridon brand worm drive hose clamps, high-torque clamps, constant tension clamps and a host of specialty and custom clamping products, available in a variety of material types and configurations. Our one-piece mechanical design locks the housing directly to the band to provide maximum strength and anti-shear protection.

Let us help you find a clamp or design one that fits your specific requirements.



FULL-SIZE 9/16" WORM DRIVE CLAMPS

The industry standard, these versatile clamps have a wide range of applications. From simple home and auto repair to heavy industrial uses, you can be sure there's a full-size clamp to handle the job.

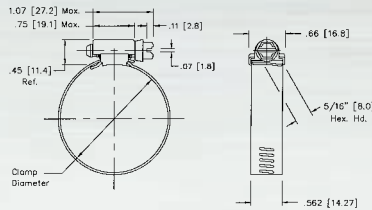

Ideal 50 Series / Tridon 150 Series

Our most popular full-size clamp.

Screw: 5/16" hex-head. Plated carbon steel.

Band and housing: 9/16" design. 201/301 stainless steel.

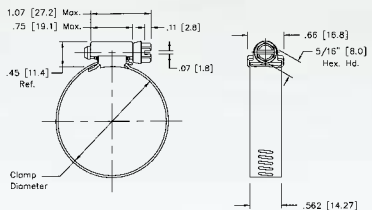

Ideal 63 Series / Tridon 225 Series

High-nickel grade stainless steel clamp for boating applications and other corrosive environments.

Screw: 5/16" hex-head. Corrosion-resistant high-nickel grade stainless steel.

Band and housing: 9/16" design. High-nickel grade stainless steel.

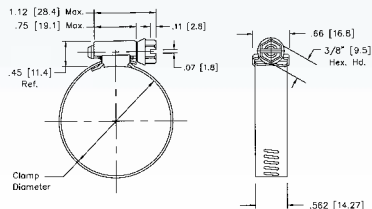

Ideal 64 Series (Tridon N/A)

All stainless steel construction especially suited to industrial applications.

Screw: 3/8" hex-head. 410 stainless steel.

Band and housing: 9/16" design. 201/301 grade stainless steel.

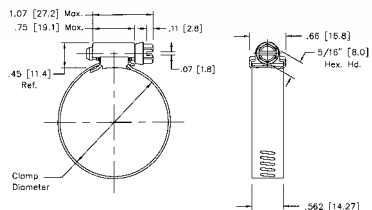

Ideal 68 Series (Tridon N/A)

All stainless steel construction especially suited to industrial applications.

Screw: 5/16" hex-head. 410 stainless steel.

Band and housing: 9/16" design. 201/301 grade stainless steel.

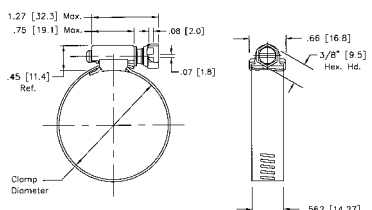

Combo-Hex®

Combo-Hex clamps are the clamps professional mechanics choose most often. Particularly helpful in hard-to-reach areas, they feature an exclusive, safety-collared, deep-slotted screw design that prevents screwdrivers from slipping and puncturing the hose wall. Combo-Hex clamps can be installed with a screwdriver, nutdriver or socket wrench.

Ideal 54 Series (Tridon N/A)

The professional mechanic's choice.

Screw: 3/8" safety-collared hex-head. Plated carbon steel.

Band and housing: 9/16" design. 201/301 stainless steel.

N/A - Not Available