



Clamp Adapters

Female NPT Adapters - 22MP

B

| Tube O.D. x NPT Size | Dimension A | 304 Part Number | 316L Part Number |
|----------------------|-------------|-----------------|------------------|
| 1/2" x 1/8" | 1.250 | --- | 22MP-R50-125 * |
| 1/2" x 1/4" | 1.500 | --- | 22MP-R5025 * |
| 1/2" x 3/8" | 1.500 | --- | 22MP-R50375 * |
| 1/2" x 3/4" | 1.500 | --- | 22MP-R5075 * |
| 3/4" x 1/4" | 1.500 | --- | 22MP-R7525 * |
| 3/4" x 1/2" | 1.625 | --- | 22MP-R7550 * |
| 1" x 1/4" | 1.625 | --- | 22MP-R10025 |
| 1" x 3/8" | 1.625 | 22MP-G100375 | 22MP-R100375 |
| 1" x 1/2" | 1.625 | 22MP-G10050 | 22MP-R10050 |
| 1" x 3/4" | 1.625 | 22MP-G10075 | 22MP-R10075 |
| 1" x 1" | 1.625 | 22MP-G100 | 22MP-R100 |
| 1" x 1 1/4" | 1.625 | 22MP-G100125 | --- |
| 1" x 2" | 2.500 | 22MP-G100200 | 22MP-R100200 |
| 1 1/2" x 1/4" | 1.625 | 22MP-G15025 | 22MP-R15025 |
| 1 1/2" x 3/8" | 1.625 | 22MP-G150375 | --- |
| 1 1/2" x 1/2" | 1.625 | 22MP-G15050 | --- |
| 1 1/2" x 3/4" | 1.625 | 22MP-G15075 | 22MP-R15075 |
| 1 1/2" x 1" | 2.250 | 22MP-G150100 | 22MP-R150100 |
| 1 1/2" x 1 1/4" | 2.250 | 22MP-G150125 | --- |
| 1 1/2" x 1 1/2" | 2.250 | 22MP-G150 | 22MP-R150 |
| 1 1/2" x 2" | 2.500 | 22MP-G150200 | 22MP-R150200 |
| 1 1/2" x 2 1/2" | 2.500 | 22MP-G150250 | --- |
| 2" x 1/2" | 1.687 | 22MP-G20050 | 22MP-R20050 |
| 2" x 3/4" | 1.687 | 22MP-G20075 | 22MP-R20075 |
| 2" x 1" | 1.687 | 22MP-G200100 | 22MP-R200100 |
| 2" x 1 1/4" | 1.656 | 22MP-G200125 | 22MP-R200125 |
| 2" x 1 1/2" | 2.344 | 22MP-G200150 | 22MP-R200150 |
| 2" x 2" | 2.406 | 22MP-G200 | 22MP-R200 |
| 2" x 2 1/2" | 2.406 | 22MP-G200250 | --- |
| 2 1/2" x 2" | 2.093 | 22MP-G250200 | 22MP-R250200 |
| 2 1/2" x 2 1/2" | 2.187 | 22MP-G250 | 22MP-R250 |
| 3" x 1 1/2" | 2.187 | 22MP-G300150 | --- |
| 3" x 2" | 2.187 | 22MP-G300200 | --- |
| 3" x 2 1/2" | 2.187 | --- | 22MP-R300250 |
| 3" x 3" | 2.187 | 22MP-G300 | 22MP-R300 |
| 4" x 4" | 3.652 | 22MP-G400 | 22MP-R400 |

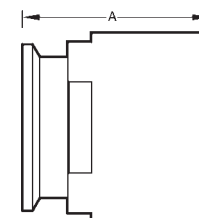

* no wrench flats