

V-Series Snap-Tite 'H' Interchange (Valved Coupler)

Part Number	Body Size	Thread Size	Body Material	Weight (lb)	List Price	Bag Qty	Pack Qty
2VF1	1/4"	1/8"-27 NPTF	steel	0.22	\$17.62	5	50
2VF2	1/4"	1/4"-18 NPTF	steel	0.20	18.00	5	50
2VF2-B	1/4"	1/4"-18 NPTF	brass	0.20	23.15	5	50
2VF2-SS	1/4"	1/4"-18 NPTF	316 SS	0.20	78.28	5	50
2VOF2	1/4"	7/16"-20 ORB	steel	0.23	19.35	5	50
2VBF2	1/4"	G1/4" BSPP	steel	0.20	17.62	5	50
2VBF2-B	1/4"	G1/4" BSPP	brass	0.20	21.99	5	50
2VBF2-SS	1/4"	G1/4" BSPP	316 SS	0.20	78.28	5	50
3VF3	3/8"	3/8"-18 NPTF	steel	0.37	24.48	5	50
3VF3-B	3/8"	3/8"-18 NPTF	brass	0.37	30.10	5	50
3VF3-SS	3/8"	3/8"-18 NPTF	316 SS	0.38	112.43	5	50
3VOF3	3/8"	9/16"-18 ORB	steel	0.40	25.20	5	50
3VBF3	3/8"	G3/8" BSPP	steel	0.37	23.98	5	50
3VBF3-B	3/8"	G3/8" BSPP	brass	0.37	28.61	5	50
3VBF3-SS	3/8"	G3/8" BSPP	316 SS	0.38	112.43	5	50
3VF4	3/8"	1/2"-14 NPTF	steel	0.49	24.96	5	50
4VF4	1/2"	1/2"-14 NPTF	steel	0.49	29.76	5	25
4VF4-B	1/2"	1/2"-14 NPTF	brass	0.49	44.10	5	25
4VF4-SS	1/2"	1/2"-14 NPTF	316 SS	0.52	154.90	5	25
4VOF4	1/2"	3/4"-16 ORB	steel	0.54	30.62	5	25
4VBF4	1/2"	G1/2" BSPP	steel	0.49	29.16	5	25
4VBF4-B	1/2"	G1/2" BSPP	brass	0.49	41.98	5	25
4VBF4-SS	1/2"	G1/2" BSPP	316 SS	0.52	154.90	5	25
4VF6	1/2"	3/4"-14 NPTF	steel	0.58	36.40	5	25
6VF6	3/4"	3/4"-14 NPTF	steel	0.88	46.11	5	20
6VF6-B	3/4"	3/4"-14 NPTF	brass	0.88	68.46	5	20
6VF6-SS	3/4"	3/4"-14 NPTF	316 SS	0.94	221.76	5	20
6VOF6	3/4"	1-1/16"-12 ORB	steel	0.99	47.42	5	20
6VBF6	3/4"	G3/4" BSPP	steel	0.88	45.15	5	20
6VBF6-B	3/4"	G3/4" BSPP	brass	0.88	68.46	5	20
6VBF6-SS	3/4"	G3/4" BSPP	316 SS	0.94	221.76	5	20
8VF8	1"	1"-11 1/2 NPTF	steel	1.33	71.55	-	10
8VF8-B	1"	1"-11 1/2 NPTF	brass	1.33	106.85	-	10
8VF8-SS	1"	1"-11 1/2 NPTF	316 SS	1.33	341.84	-	10
8VOF8	1"	1-5/16"-12 ORB	steel	1.42	73.62	-	10
8VBF8	1"	G1" BSPP	steel	1.33	70.12	-	10
8VBF8-B	1"	G1" BSPP	brass	1.33	106.85	-	10
8VBF8-SS	1"	G1" BSPP	316 SS	1.33	341.84	-	10
10VF10 ¹	1-1/4"	1-1/4"-11 1/2 NPTF	steel	1.94	166.44	-	1
10VF10-B ¹	1-1/4"	1-1/4"-11 1/2 NPTF	brass	1.94	219.63	-	1
10VF10-SS ¹	1-1/4"	1-1/4"-11 1/2 NPTF	316 SS	1.95	564.99	-	1
10VOF10 ¹	1-1/4"	1-5/8"-12 ORB	steel	1.92	171.25	-	1
10VBF10 ¹	1-1/4"	G1-1/4" BSPP	steel	1.94	163.12	-	1
10VBF10-B ¹	1-1/4"	G1-1/4" BSPP	brass	1.94	219.63	-	1
10VBF10-SS ¹	1-1/4"	G1-1/4" BSPP	316SS	1.95	564.99	-	1
12VF12 ¹	1-1/2"	1-1/2"-11 1/2 NPTF	steel	2.95	234.34	-	1
12VF12-B ¹	1-1/2"	1-1/2"-11 1/2 NPTF	brass	2.95	304.90	-	1
12VF12-SS ¹	1-1/2"	1-1/2"-11 1/2 NPTF	316 SS	2.94	767.26	-	1
12VOF12 ¹	1-1/2"	1-7/8"-12 ORB	steel	3.01	241.29	-	1
12VBF12 ¹	1-1/2"	G1-1/2" BSPP	steel	2.95	229.80	-	1
12VBF12-B ¹	1-1/2"	G1-1/2" BSPP	brass	2.95	304.90	-	1
12VBF12-SS ¹	1-1/2"	G1-1/2" BSPP	316 SS	2.95	767.26	-	1
16VF16 ¹	2"	2"-11 1/2 NPTF	steel	6.19	445.64	-	1
16VF16-B ¹	2"	2"-11 1/2 NPTF	brass	6.19	646.13	-	1
16VF16-SS ¹	2"	2"-11 1/2 NPTF	316 SS	6.20	1375.56	-	1
16VBF16 ¹	2"	G2" BSPP	steel	6.19	436.95	-	1
16VBF16-B ¹	2"	G2" BSPP	brass	6.19	646.21	-	1
16VBF16-SS ¹	2"	G2" BSPP	316 SS	6.19	1375.56	-	1

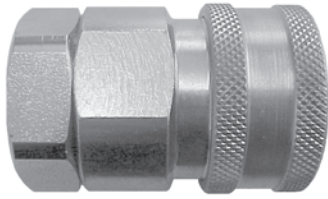

(Female Thread)

V-Series

¹ New improved valve design

V-Series Snap-Tite 'H' Interchange (Coupler Rigid Dust Plug)



Part Number	Body Size	Cap Lanyard	Body Material	Weight (lb)	List Price	Bag Qty	Pack Qty
2VDP-A	1/4"	SS bead chain	aluminum	0.02	\$9.54	5	50
3VDP-A	3/8"	SS bead chain	aluminum	0.02	10.25	5	50
4VDP-A	1/2"	SS bead chain	aluminum	0.03	10.89	5	25
6VDP-A	3/4"	SS bead chain	aluminum	0.09	14.71	5	20
8VDP-A	1"	SS bead chain	aluminum	0.14	16.38	---	10
10VDP-A	1-1/4"	SS bead chain	aluminum	0.29	24.33	---	10
12VDP-A	1-1/2"	SS bead chain	aluminum	0.31	49.77	---	10
16VDP-A	2"	SS bead chain	aluminum	0.49	84.90	---	10