

Two Way Male Outlet - Roof Connections

26-294 / 26-296

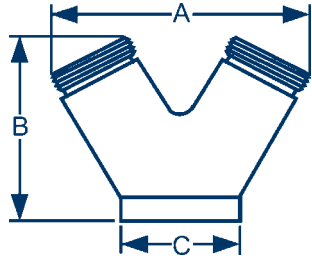

26-294

Size	Dimensions (inches)		
	A	B	C
4 x 2½ x 2½ *	7-7/8	5-3/16	5-1/4
6 x 2½ x 2½ *	8-3/16	6-3/8	7-5/8

* Underwriters Listed

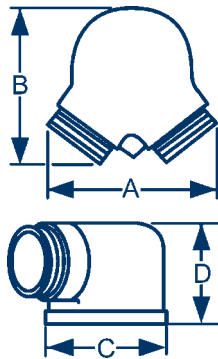

26-296

Size	Dimensions (inches)			
	A	B	C	D
4 x 2½ x 2½	7-1/2	6-3/4	5-1/8	4-1/2
6 x 2½ x 2½ *	9	8-1/2	7-1/2	5

* Underwriters Listed

Used to create roof connections, fire pump test connections, wall hydrants or sidewalk (free standing) hydrants. Provides 250 GPM minimum per outlet.

- Cast brass finish
- For use up to **175 PSI**
- Other sizes, threads and finishes are also available, consult the factory for pricing and availability

Inlet Female NPT	(2) Outlets Male NPT	Dixon Part #	Powhatan Part #
4" (back)	2½"	FRC4025	26-294-00001
6" (back)	2½"	FRC6025	26-294-00010
4" (bottom)	2½"	90FRC4025	26-296-00002
6" (bottom)	2½"	90FRC6025	26-296-00008
Inlet Female NPT	(2) Outlets Male NH (NST)	Dixon Part #	Powhatan Part #
4" (back)	2½"	FRC4025F	26-294-00003
6" (back)	2½"	FRC6025F	26-294-00011
4" (bottom)	2½"	90FRC4025F	26-296-00003
6" (bottom)	2½"	90FRC6025F	26-296-00011
Inlet Female NPT	(2) Outlets Male NYFD	Dixon Part #	Powhatan Part #
6" (back)	2½"	FRC6025NYFD	26-294-00108