

## Lockable Angle Valves

- Rotation of cap controls gravity flow from above ground gasoline storage tank
- Inlet (pipe from storage tank) x outlet (for hose and nozzle dispensing)
- Lockable (lock not included)
- Cast non-ferrous alloy construction



Female NPT Inlet	Female NPT Outlet	Part #	Price/E
1"	1"	500AV	\$85.00
1 1/4"	1 1/4"	525AV	85.00

## Full Flow Aluminum Ball Valves

- High flow rate; low pressure drop
- Wetted parts are aluminum and stainless steel
- Seals are FPM (Viton® and PTFE Teflon®)
- Spindle can be disassembled even when ball valve is installed
- Working pressure: **150 PSI**
- Available in 2", 3" and 4" in standard flow and two-way flow
- Female NPT outlets are standard
- Optional flanges are available

### One-Way Ball Valves / Female NPT ends

- Two ports - one inlet and one outlet

Size	Part #	Price / Each
2"	1WAYBV200	\$700.00
3"	1WAYBV300	930.00
4"	1WAYBV400	1350.00



### Two-Way Ball Valves / Female NPT ends

- Three ports - one inlet and two outlets, valve directs the flow from the inlet to either of the two outlets
- Commonly used for switching compartments or tanks

Size	Part #	Price / Each
2"	2WAYBV200	\$975.00
3"	2WAYBV300	1250.00
4"	2WAYBV400	2725.00



## Custom Design Ball Valves Options

### Body Only

- The one-way ball valve is available in body only featuring two flanged ports.
- The two-way ball valve is available in body only featuring three flanged ports.
- Select socket weld, butt weld or female threaded ends.
- Examples: socket weld x female NPT on one-way valve or butt weld x female NPT x butt weld on two-way valve.

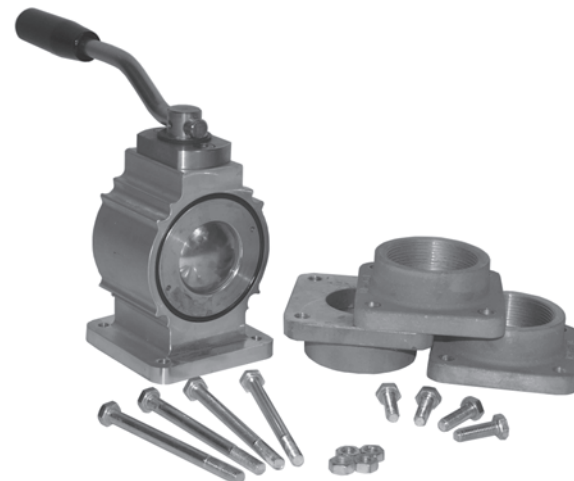

0 Tank Truck Fittings