

Bevel Seat Elbows

A 90° Bevel Seat Elbows - **B2F**

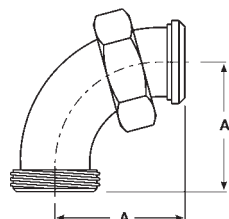

Tube OD	Dimension A	304 Stainless Steel	
		Part #	Price/E
1½"	2.968	B2F-G150	\$143.00
2"	3.750	B2F-G200	169.20
2½"	4.625	B2F-G250	234.65
3"	5.406	B2F-G300	303.25

Hex nut is CF8 (304 stainless steel)

A Plain Bevel Seat x Plain Bevel Seat with Hex Nut 90° Elbows - **B2E**

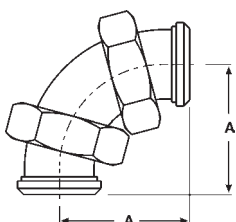

Tube OD	Dimension A	304 Stainless Steel	
		Part #	Price/E
1½"	2.968	B2E-G150	\$181.00
2"	3.750	B2E-G200	212.70
3"	5.406	B2E-G300	361.80

Hex nut is CF8 (304 stainless steel)

A Threaded Bevel Seat x Plain Bevel Seat with Hex Nut 45° Elbows - **B2P**

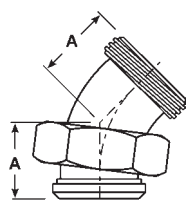

Tube OD	Dimension A	304 Stainless Steel	
		Part #	Price/E
1½"	1.655	B2P-G150	\$146.80
2"	2.000	B2P-G200	186.75
3"	2.178	B2P-G300	324.30

Hex nut is CF8 (304 stainless steel)

Plain Bevel Seat x Male NPT Adapters - **14-19**

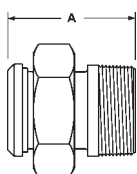

Tube OD	Dimension A	304 Stainless Steel	
		Part #	Price/E
1½"	3.250	14-19-G150	\$426.85
2"	3.312	14-19-G200	425.30
3"	4.250	14-19-G300	625.90

Hex nut is CF8 (304 stainless steel)

Plain Bevel Seat Tygon Hose Adapters - **14AHT**

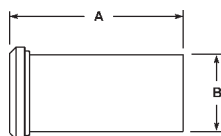

Thread Size	Dimensions		304 Stainless Steel	
	A	B	Part #	Price / E
1½"	4.719	1.500	14AHT-G150	\$103.80
2"	4.719	2.000	14AHT-G200	128.60
3"	4.906	3.000	14AHT-G300	270.25

Threaded Bevel Seat Tygon Hose Adapters - **15AHT**

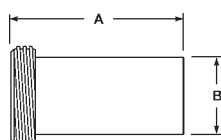

Thread Size	Dimensions		304 Stainless Steel	
	A	B	Part #	Price / E
1½"	4.500	1.500	15AHT-G150	\$223.45
2"	4.500	2.000	15AHT-G200	289.60
3"	4.500	3.000	15AHT-G300	731.50