

CIP Internal Expansion (IX) Sanitary Hose Couplings

Meets  (3A), FDA and USDA sanitary standards. **Clean-In-Place (CIP)** compliant.
 Flow Chief internal expansion (IX) fittings are **only** to be used with Flow Chief stainless steel ferrules.
 Flow Chief Sanitary fittings are used in the food, dairy and beverage industries.

Sanitary Clamp End Stems

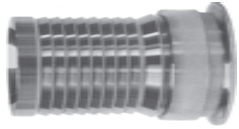

- See pages 329-332 for sanitary style gaskets
- See pages 333-335 for sanitary style clamps
- Special plug is required to expand 3A compliant fittings
- Special adapter plate is required to expand 1½" 3A compliant fittings



Hose Size	Part #	Price/E
1½"	IXSE24-3A	\$148.40
2"	IXSE32-3A	185.50
3"	IXSE48-3A	344.50

Tube Weld End Stem

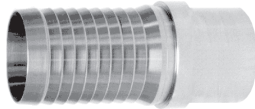

- Special plug is required to expand 3A compliant fittings.



Hose Size	Part #	Price/E
2"	IXPE32-3A	\$172.80

Special Plug for 3A Compliant IX Fittings



Hose Size	Expansion Plug Part #
1½"	IXFDPLG137
2"	IXFDPLG187
3"	IXFDPLG287

Flow Chief Ferrules



- Flow Chief ferrules are 304 stainless steel
- The ferrule I.D.s are designed in increments of 1/16"

Hose I.D.	Hose O.D. Range		Part #	Price/E
	From	To		
1½" *	1-56/64"	1-59/64"	24PFX1.937	\$90.05
	1-60/64"	1-63/64"	24PFX2.000	90.05
	2"	2-3/64"	24PFX2.062	90.05
	2-4/64"	2-7/64"	24PFX2.125	90.05
	2-8/64"	2-11/64"	24PFX2.187	90.05
	2-12/64"	2-15/64"	24PFX2.250	90.05
	2-16/64"	2-19/64"	24PFX2.312**	90.05
2" *	2-28/64"	2-31/64"	32PFX2.500	103.80
	2-32/64"	2-35/64"	32PFX2.562	103.80
	2-36/64"	2-39/64"	32PFX2.625	103.80
	2-40/64"	2-43/64"	32PFX2.687	103.80
	2-44/64"	2-47/64"	32PFX2.750	103.80
	2-48/64"	2-51/64"	32PFX2.812	103.80
	2-52/64"	2-55/64"	32PFX2.875	103.80
2½"	3"	3-3/64"	40PFX3.062	143.75
	3-4/64"	3-7/64"	40PFX3.125	143.75
	3-12/64"	3-15/64"	40PFX3.250	143.75
	3-16/64"	3-19/64"	40PFX3.312	143.75
	3-20/64"	3-23/64"	40PFX3.375	143.75
	3-28/64"	3-31/64"	40PFX3.500	143.75

Hose I.D.	Hose O.D. Range		Part #	Price/E
	From	To		
3"	3-32/64"	3-35/64"	48PFX3.562	\$164.30
	3-36/64"	3-39/64"	48PFX3.625	164.30
	3-40/64"	3-43/64"	48PFX3.687	164.30
	3-44/64"	3-47/64"	48PFX3.750	164.30
	3-48/64"	3-51/64"	48PFX3.812	164.30
	3-52/64"	3-55/64"	48PFX3.875	164.30
	3-56/64"	3-59/64"	48PFX3.937	164.30
4"	3-60/64"	3-63/64"	48PFX4.000	164.30
	4"	4-3/64"	48PFX4.062	164.30
	4-4/64"	4-7/64"	48PFX4.125	164.30
	4-36/64"	4-39/64"	64PFX4.625	207.75
	4-40/64"	4-43/64"	64PFX4.687	207.75
	4-44/64"	4-47/64"	64PFX4.750	207.75
	4-48/64"	4-51/64"	64PFX4.812	207.75
4-52/64"	4-55/64"	64PFX4.875	207.75	
	4-56/64"	4-59/64"	64PFX4.937	207.75

* **Note:** 1½" and 2" ferrules are not serrated
 ** Consult the factory for working pressure

Consult Dixon for equipment to install (IX) fittings. Special ends and configurations are also available.