



Hydraulic Fittings

Hydraulic Hose Couplings Stems



Plated Steel Stems

NPTF Size	Plated Steel Part #	Price / Each
3/8"	MSC	\$5.10
1/2"	HY4	11.70
3/4"	MS6	8.30
1"	HY8	16.20



Plated Iron Stems

NPTF Size	Plated Iron Part #	Price / Each
1-1/4"	HY10	\$29.10
1-1/2"	HY12	33.00
2"	HY16	39.40

Note: stems have a collar behind the hex to engage fingers

Clamps for Wire Braid or Spiral Ply Hose



2-bolt Clamps for 1 Wire Hose

Hose I.D.	O.D. Range	Part #	Price/E	Torque
3/8"	48/64" - 50/64"	HD1-3	\$12.50	12
1/2"	56/64" - 60/64"	HD1-4	14.70	18
3/4"	1-10/64" - 1-14/64"	HD1-6	18.00	18
1"	1-29/64" - 1-35/64"	HD1-8	21.70	36



2-bolt Clamps for 2 Wire Hose

Hose I.D.	O.D. Range	Part #	Price/E	Torque
3/8"	52/64" - 56/64"	HD2-3	\$10.80	12
1/2"	60/64" - 1"	HD2-4	15.00	18
3/4"	1-14/64" - 1-18/64"	HD2-6	15.45	18
1"	1-33/64" - 1-39/64"	HD2-8	24.30	36

4-bolt Clamps for Hydraulic Hose
with 1, 2 or 4 Wire Braids or Spiral Plies

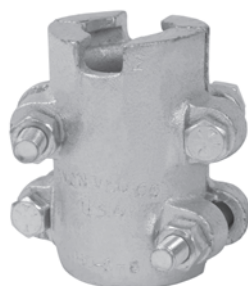

Hose I.D.	O.D. Range	Part #	Price/Each	Torque*
1-1/4"	1-48/64" - 2"	HD2-9	\$34.00	64
1-1/4"	2" - 2-8/64"	HD2-10	31.00	64
1-1/2"	2-12/64" - 2-18/64"	HD2-11	31.00	64
1-1/2"	2-16/64" - 2-20/64"	HD2-12	31.00	64
2"	2-36/64" - 2-48/64"	HD2-15	45.00	90
2"	2-48/64" - 2-58/64"	HD2-16	45.85	90

* Recommended torque rating in ft/lbs.

Hydraulic Hose Clamps



- Plated iron
- Le-Hi style hydraulic hose clamps are for use *only on 1 or 2 wire hydraulic hoses that have outside diameters that fall within recommended ranges* as shown in this catalog.
- This clamp *should not be used on 4 or 6 wire hydraulic hose* even when hose falls within recommended ranges.

Hose I.D.	O.D. Range	Plated Iron Part #	Price/Each	Torque*
3/8"	50/64" - 52/64"	HRC-037	\$10.75	18
1/2"	57/64" - 1"	HRC-050	17.10	18
3/4"	1-16/64" - 1-20/64"	HRC-075	14.85	36
1"	1-37/64" - 1-41/64"	HRC-100	16.20	64
1-1/4"	1-54/64" - 1-62/64"	HRC-125	27.00	90
1-1/2"	2-10/64" - 2-18/64"	HRC-150	29.60	90
2"	2-43/64" - 2-52/64"	HRC-200	35.80	90

* Recommended torque rating in ft/lbs.