



**A**  
Cam &  
Groove

Cam and Groove

**Type F Reducing Adapters x Male NPT**

Size	Aluminum		Pkg Qty	Stainless Steel	
	Part #	Price/E		Part #	Price/E
1½" x 2"	1520-F-AL	\$39.70	---	---	---
2" x 1½"	2015-F-AL	40.00	---	2015-F-SS <sup>1</sup>	\$365.00
2" x 3"	2030-F-AL	61.70	---	---	---
3" x 1½"	3015-F-AL	53.80	10	3015-F-SS <sup>1</sup>	391.00
3" x 2"	3020-F-AL	56.70	10	3020-F-SS	399.00
3" x 4"	3040-F-AL	73.70	10	---	---
4" x 3"	4030-F-AL	79.85	10	4030-F-SS <sup>1</sup>	574.10

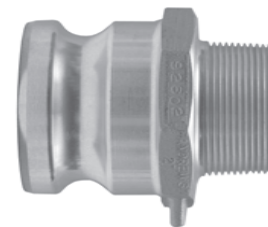

Type F

**Type B Reducing Couplers x Male NPT**

Size	Aluminum		Pkg Qty	Stainless Steel	
	Part #	Price/E		Part #	Price/E
1½" x 1"	1510-B-AL	\$55.75	10	1510-B-SS <sup>1</sup>	\$295.00
2" x 1½"	2015-B-AL	58.90	10	2015-B-SS <sup>1</sup>	322.10
2" x 3"	2030-B-AL	64.75	---	---	---
3" x 2"	3020-B-AL	65.20	10	3020-B-SS <sup>1</sup>	344.65
3" x 4"	3040-B-AL	96.10	10	---	---
4" x 3"	4030-B-AL	102.90	5	4030-B-SS <sup>1</sup>	464.90

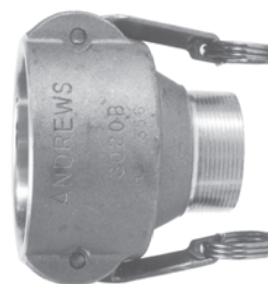

Type B

**Note:** If a coupling is a reducing size, the coupler or adapter is the first size (i.e., a 4030-C-AL is a 4" coupler to a 3" hose shank).

<sup>1</sup> Parts are produced as a welded fabrication.

Optional Pkg./Box Quantity Shown