

## Female Bulkhead Connector – Tube To NPT

ØD in	C NPT	Cat. No. (fractional inch)	E in	F1 mm	F2 mm	K max in	L1 in	L2 in	T min in	Scale oz
1/8	1/8	PCNY2705-02-02	.37	13	13	.28	.41	.73	.41	.75
5/32	1/8	PCNY2705-02-02.5	.37	13	13	.28	.41	.73	.41	.88
5/32	1/4	PCNY2705-04-02.5	.55	13	16	.32	.41	.73	.41	.99
1/4	1/8	PCNY2705-02-04	.37	18	17	.32	.55	.96	.61	1.23
1/4	1/4	PCNY2705-04-04	.55	18	17	.32	.55	1.18	.61	1.41
3/8	1/4	PCNY2705-04-06	.55	22	22	.33	.57	.89	.73	2.57
3/8	3/8	PCNY2705-06-06	.55	22	22	.33	.57	.89	.73	2.65

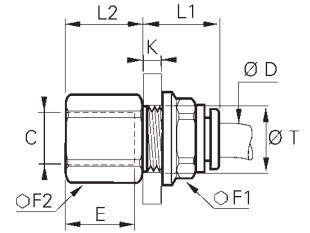

## “Y” Male – Fractional Inch Tube To NPT

ØD in	C NPT	Cat. No.	F mm	H in	K in	L in	N in	Scale oz
5/32	1/8	PCNY2801-02.5-02.5-02	11	1.28	.33	.69	.35	.42
5/32	1/4	PCNY2801-02.5-02.5-04	14	1.30	.33	.69	.35	.79
1/4	1/8	PCNY2801-04-04-02	11	1.61	.43	.87	.45	.59
1/4	1/4	PCNY2801-04-04-04	14	1.56	.43	.87	.45	.80
3/8	1/4	PCNY2801-06-06-04	17	2.24	.63	1.30	.67	1.61
3/8	3/8	PCNY2801-06-06-06	18	2.28	.63	1.30	.67	1.94

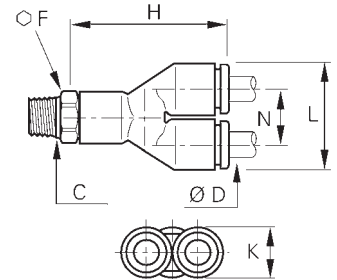

## “Y” – Fractional Inch Tube To Tube

ØD1 in	ØD2 in	Cat. No.	H in	K in	L in	N in	Scale oz
1/8	1/8	PCNY2803-02-02	.69	.33	1.12	.35	.16
5/32	5/32	PCNY2803-02.5-02.5	.69	.34	1.12	.35	.14
1/4	1/4	PCNY2803-04-04	.87	.43	1.42	.45	.24
5/16	5/16	PCNY2803-05-05	1.10	.53	1.77	.57	.46
3/8	3/8	PCNY2803-06-06	1.30	.63	2.09	.67	.59
1/8	1/4	PCNY2803-02-04	.87	.43	1.42	.45	.20
5/32	1/4	PCNY2803-02.5-04	.87	.43	1.42	.45	.43
1/4	3/8	PCNY2803-04-06	1.30	.63	1.31	.67	.50
3/8	1/2	PCNY2803-06-08	1.30	.63	2.09	.67	.59

