

## Nylon Push-To-Connect Fittings For Industrial Applications

### Union – Fractional Inch Tube To Tube

ØD in	Cat. No.	G in	L in	Scale oz
1/8	PCNY2403-02-02	.34	.97	.11
5/32	PCNY2403-02.5-02.5	.33	.98	.07
3/16	PCNY2403-03-03	.43	1.44	.39
1/4	PCNY2403-04-04	.43	1.16	.14
5/16	PCNY2403-05-05	.53	1.50	.25
3/8	PCNY2403-06-06	.63	1.65	.40
1/2	PCNY2403-08-08	.87	2.17	.95

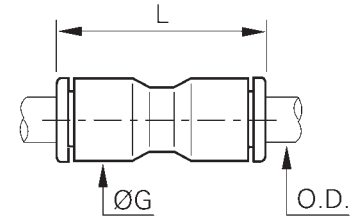

### Unequal Union – Fractional Inch Tube To Tube

ØD1 in	ØD2 in	Cat. No.	G in	L in	Scale oz
1/8	5/32	PCNY2403-02-02.5	.33	.96	.11
1/8	1/4	PCNY2403-02-04	.43	1.32	.34
5/32	1/4	PCNY2403-02.5-04	.43	1.16	.34
1/4	5/16	PCNY2403-04-05	.53	1.44	.40
3/8	1/4	PCNY2403-06-04	.63	1.61	.50
3/8	1/2	PCNY2403-06-08	.87	2.17	.55

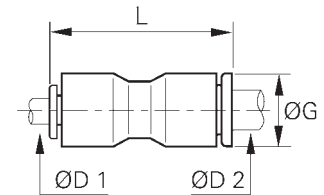

### Male Connector – Fractional Inch Tube To Male NPT

ØD1 in	C NPT	Cat. No.	F1 mm	F2 in	H in	K in	Scale oz
1/8	1/16	PCNY2404-02-01	10	.07	.413	.433	.24
1/8	1/8	PCNY2404-02-02	11	.07	.283	.472	.25
1/8	1/4	PCNY2404-02-04	14	.07	.315	.591	.59
5/32	1/8	PCNY2404-02.5-02	11	7/64	.334	.472	.26
5/32	1/4	PCNY2404-02.5-04	14	7/64	.275	.590	.56
3/16	1/8	PCNY2404-03-02	7/16"	1/8	.61	.51	.49
3/16	1/4	PCNY2404-03-04	9/16"	5/32	.59	.65	.97
1/4	1/8	PCNY2404-04-02	11	5/32	.472	.472	.26
1/4	1/4	PCNY2404-04-04	14	5/32	.374	.590	.50
1/4	3/8	PCNY2404-04-06	18	3/16	.295	.767	.88
5/16	1/8	PCNY2404-05-02	13	3/16	.787	.551	.45
5/16	1/4	PCNY2404-05-04	14	1/4	.661	.590	.58
5/16	3/8	PCNY2404-05-06	18	1/4	.464	.767	.89
3/8	1/8	PCNY2404-06-02	16	5/32	.894	.689	.79
3/8	1/4	PCNY2404-06-04	16	9/32	.807	.689	.73
3/8	3/8	PCNY2404-06-06	18	9/32	.689	.767	.97
3/8	1/2	PCNY2404-06-08	22	9/32	.610	.945	2.00
1/2	1/4	PCNY2404-08-04	22	1/4	1.1	.945	1.62
1/2	3/8	PCNY2404-08-06	22	9/32	1.1	.945	.89
1/2	1/2	PCNY2404-08-08	22	9/32	1.1	.945	2.51

