

Male Branch Tee N2601

INCH OD Tubes x Male NPT Threads

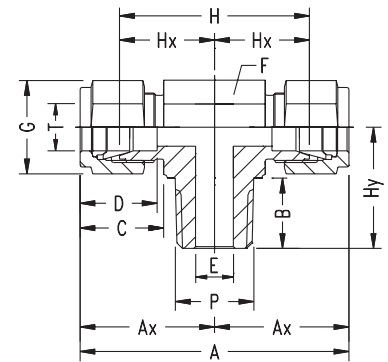

Part No.	T Tube OD	P NPT Male	A	Ax	B	C	D	E min.	F	G A/F	H A/F	Hx	Hy
N2601-02-02-02	1/8	1/8	47.2	23.6	9.6	15.3	12.7	2.4	11	11	34.0	17.0	17.8
N2601-02-02-04	1/8	1/4	49.2	24.6	14.3	15.3	12.7	2.4	14	11	36.0	18.0	23.4
N2601-04-04-02	1/4	1/8	53.8	26.9	9.6	17.8	15.3	4.8	14	14	39.2	19.6	18.8
N2601-04-04-04	1/4	1/4	53.8	26.9	14.3	17.8	15.3	4.8	14	14	39.2	19.6	23.4
N2601-04-04-06	1/4	3/8	59.4	29.7	14.3	17.8	15.3	4.8	17	14	44.8	22.4	26.2
N2601-04-04-08	1/4	1/2	63.6	31.8	19.1	17.8	15.3	4.8	22	14	44.8	24.4	33.0
N2601-06-06-04	3/8	1/4	61.0	30.5	14.3	19.3	16.8	7.1	17	17	46.2	23.1	25.4
N2601-06-06-06	3/8	3/8	62.4	31.2	14.3	19.3	16.8	7.1	17	17	47.8	23.9	26.2
N2601-06-06-08	3/8	1/2	66.0	33.0	19.1	19.3	16.8	7.1	22	17	51.8	25.9	33.0
N2601-08-08-04	1/2	1/4	72.0	36.0	14.3	21.8	22.9	4.8	22	22	51.8	25.9	28.2
N2601-08-08-06	1/2	3/8	72.0	36.0	14.3	21.8	22.9	9.6	22	22	51.8	25.9	28.2
N2601-08-08-08	1/2	1/2	72.0	36.0	19.1	21.8	22.9	10.4	22	22	51.8	25.9	33.0
N2601-10-10-08	5/8	1/2	76.2	38.1	19.1	21.8	24.4	11.9	22	25	55.8	27.9	35.0
N2601-12-12-08	3/4	1/2	79.8	39.9	19.1	21.8	24.4	11.9	27	29	59.4	29.7	36.8
N2601-12-12-12	3/4	3/4	79.8	39.9	19.1	21.8	24.4	15.8	27	29	59.4	29.7	36.8
N2601-16-16-12	1	3/4	98.0	49.0	19.1	26.4	31	15.8	35	38	73.6	36.8	41.6
N2601-16-16-16	1	1	98.0	49.0	23.8	26.4	31	22.3	35	38	73.6	36.8	46.5
N2601-20-20-20	1-1/4	1-1/4	133.0	66.5	23.8	38.8	41.1	27.6	46	50	89.0	44.5	47.6
N2601-24-24-24	1-1/2	1-1/2	156.0	78.0	26.2	45.2	50.0	34.0	55	57	101.6	50.8	60.4

Female Branch Tee N2602

INCH OD Tubes x Female NPT Threads

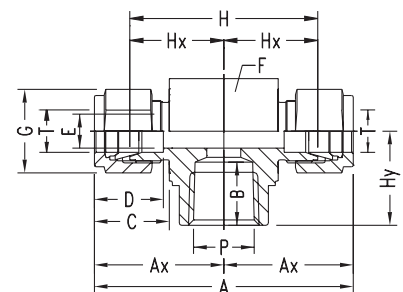

Part No.	T Tube OD	P NPT Female	A	Ax	B	C	D	E min.	F A/F	G A/F	H	Hx	Hy
N2602-02-02-02	1/8	1/8	49.2	24.6	10.4	15.3	12.7	2.4	14	11	36.0	18.0	19.0
N2602-04-04-02	1/4	1/8	53.8	26.9	10.4	17.8	15.3	4.8	14	14	39.2	19.6	19.0
N2602-04-04-04	1/4	1/4	59.4	27.9	15.0	17.8	15.3	4.8	19	14	44.8	22.4	22.4
N2602-06-06-04	3/8	1/4	62.4	31.2	15.0	19.3	16.8	7.1	16	16	47.8	23.9	22.4
N2602-06-06-06	3/8	3/8	66.6	33.3	15.0	19.3	16.8	7.1	19	16	51.8	25.9	22.4
N2602-08-08-06	1/2	3/8	72.0	36.0	15.0	21.8	22.9	10.4	19	19	51.8	25.9	22.4
N2602-08-08-08	1/2	1/2	77.8	38.9	19.8	21.8	22.9	10.4	22	22	57.4	28.7	28.5
N2602-12-12-12	3/4	3/4	89.4	44.7	20.6	21.8	24.4	15.8	35	22	69.2	34.6	31.8
N2602-16-16-12	1	3/4	98.0	49.0	20.6	26.4	31.2	22.3	35	25	73.6	36.8	31.8
N2602-16-16-16	1	1	107.2	53.6	25.4	26.4	31.2	22.3	41	38	82.8	41.4	38.1