

DIN Metric Fittings

Female Stud Coupling BSPP VS8006 Series

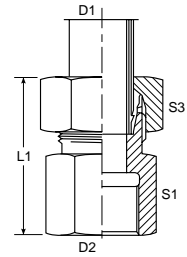

Standard Material
From Stock

PRODUCT ID	DESCRIPTION	D1	D2	L1	S1	S3	Standard Material From Stock			
							S	FG	SS	B
VS8006-L08-04	Female Stud Coupling BSPP	8	G 1/4	39	19	17	•			
VS8006-L08-06	Female Stud Coupling BSPP	8	G 3/8	40	24	17	•			
VS8006-L08-08	Female Stud Coupling BSPP	8	G 1/2	44	27	17	•			
VS8006-L10-04	Female Stud Coupling BSPP	10	G 1/4	40	19	19	•			
VS8006-L10-06	Female Stud Coupling BSPP	10	G 3/8	41	24	19	•			
VS8006-L10-08	Female Stud Coupling BSPP	10	G 1/2	45	27	19	•			
VS8006-L12-06	Female Stud Coupling BSPP	12	G 3/8	41	24	22	•			
VS8006-L12-08	Female Stud Coupling BSPP	12	G 1/2	45.5	27	22	•			
VS8006-L15-08	Female Stud Coupling BSPP	15	G 1/2	46	27	27	•			
VS8006-L18-08	Female Stud Coupling BSPP	18	G 1/2	47	27	32	•			
VS8006-L22-12	Female Stud Coupling BSPP	22	G 3/4	52	36	36	•			
VS8006-L28-16	Female Stud Coupling BSPP	28	G 1	54.5	41	41	•			
VS8006-L35-20	Female Stud Coupling BSPP	35	G 1 1/4	62.5	55	50	•			
VS8006-L42-24	Female Stud Coupling BSPP	42	G 1 1/2	65.5	60	60	•			
VS8006-S06-04	Female Stud Coupling BSPP	6	G 1/4	41	19	17	•			
VS8006-S08-04	Female Stud Coupling BSPP	8	G 1/4	41	19	19	•			
VS8006-S10-06	Female Stud Coupling BSPP	10	G 3/8	43	24	22	•			
VS8006-S12-06	Female Stud Coupling BSPP	12	G 3/8	43	24	24	•			
VS8006-S12-08	Female Stud Coupling BSPP	12	G 1/2	45.5	27	22	•			
VS8006-S14-08	Female Stud Coupling BSPP	14	G 1/2	50	27	27	•			
VS8006-S16-08	Female Stud Coupling BSPP	16	G 1/2	50	27	30	•			
VS8006-S20-12	Female Stud Coupling BSPP	20	G 3/4	56	36	36	•			
VS8006-S25-16	Female Stud Coupling BSPP	25	G 1	61.5	41	46	•			
VS8006-S30-20	Female Stud Coupling BSPP	30	G 1 1/4	68.5	55	50	•			
VS8006-S38-24	Female Stud Coupling BSPP	38	G 1 1/2	74.5	60	60	•			