

MORB-MP Straight 6401-O Series

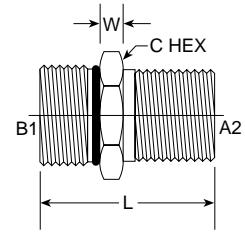

PART NO. SIZE	TUBE SIZE	B1 ORB	A2 NPTF	L LGTH	M.M.	W WIDTH	C HEX	C HEX	M.M.	Standard Material From Stock			
										S	FG	SS	B
NEW NEW 6401-02-02-O										•			
6401-03-02-O										•			
6401-04-02-O	1/4	7/16-20	1/8-27	1.070	27.18	0.280	9/16	0.562	14.27	•			
6401-04-04-O	1/4	7/16-20	1/4-18	1.230	31.24	0.310	9/16	0.562	14.27	•		•	
6401-05-02-O	5/16	1/2-20	1/8-27	1.050	26.67	0.290	5/8	0.625	15.88	•			
6401-05-04-O	5/16	1/2-20	1/8-27	1.152	29.26	0.210	5/8	0.625	15.88	•		•	
6401-06-02-O	3/8	9/16-18	1/8-27	1.110	28.19	0.340	11/16	0.687	17.45	•			
6401-06-04-O	3/8	9/16-18	1/4-18	1.290	32.77	0.310	11/16	0.687	17.45	•		•	
6401-06-06-O	3/8	9/16-18	3/8-18	1.300	33.02	0.330	11/16	0.687	17.45	•		•	
6401-06-08-O	3/8	9/16-18	1/2-14	1.390	35.31	0.240	7/8	0.875	22.23	•		•	
6401-08-04-O	1/2	3/4-16	1/4-18	1.240	31.50	0.240	7/8	0.875	22.23	•		•	
6401-08-06-O	1/2	3/4-16	3/8-18	1.360	34.54	0.340	7/8	0.875	22.23	•		•	
6401-08-08-O	1/2	3/4-16	1/2-14	1.550	39.37	0.410	7/8	0.875	22.23	•		•	
6401-08-12-O	1/2	3/4-16	3/4-14	1.590	40.39	0.260	1 1/8	1.125	28.58	•		•	
6401-10-04-O	5/8	7/8-14	1/4-18	1.450	36.83	0.400	1	1.000	25.40	•			
6401-10-06-O	5/8	7/8-14	3/8-18	1.560	39.62	0.450	1	1.000	25.40	•			
6401-10-08-O	5/8	7/8-14	1/2-14	1.690	42.93	0.410	1	1.000	25.40	•		•	
6401-10-12-O	5/8	7/8-14	3/4-14	1.770	44.96	0.410	1 1/8	1.125	28.58	•		•	
6401-12-06-O	3/4	1 1/16-12	3/8-18	1.680	42.67	0.500	1 1/4	1.250	31.75	•			
6401-12-08-O	3/4	1 1/16-12	1/2-14	1.840	46.74	0.500	1 1/4	1.250	31.75	•		•	
6401-12-12-O	3/4	1 1/16-12	3/4-14	1.730	43.94	0.380	1 1/4	1.250	31.75	•		•	
6401-12-16-O	3/4	1 1/16-12	1-11 1/2	2.120	53.85	0.460	1 3/8	1.375	34.93	•		•	
6401-14-12-O	7/8	1 3/16-12	3/4-14	1.850	46.99	0.490	1 3/8	1.375	34.93	•			
6401-14-16-O	7/8	1 3/16-12	1-11 1/2	1.980	50.29	0.440	1 3/8	1.375	34.93	•			
6401-16-12-O	1	1 5/16-12	3/4-14	2.070	52.58	0.540	1 1/2	1.500	38.10	•		•	
6401-16-16-O	1	1 5/16-12	1-11 1/2	1.900	48.26	0.500	1 1/2	1.500	38.10	•		•	
6401-16-20-O	1	1 5/16-12	1 1/4-11 1/2	2.340	59.44	0.540	1 3/4	1.750	44.45	•			
6401-20-12-O	1 1/4	1 5/8-12	3/4-14	1.900	48.26	0.540	1 7/8	1.875	47.63	•			
NEW 6401-20-16-O										•			
6401-20-20-O	1 1/4	1 5/8-12	1 1/4-11 1/2	2.170	55.12	0.580	1 7/8	1.875	47.63	•		•	
6401-20-24-O	1 1/4	1 5/8-12	1 1/2-11 1/2	2.277	57.84	0.675	2	2.000	50.80	•		•	
6401-24-16-O	1 1/2	1 7/8-12	1-11 1/2	2.210	56.13	0.670	2 1/8	2.125	53.98	•			
6401-24-16-O	1 1/2	1 7/8-12	1-11 1/2	2.220	56.39	0.670	2 1/8	2.125	53.98	•			
6401-24-20-O	1 1/2	1 7/8-12	1 1/4-11 1/2	2.250	57.15	0.670	2 1/8	2.125	53.98	•			
6401-24-24-O	1 1/2	1 7/8-12	1 1/2-11 1/2	2.280	57.91	0.650	2 1/8	2.125	53.98	•		•	
6401-32-32-O	2	2 1/2-12	2-11 1/2	2.480	62.99	0.810	2 3/4	2.750	69.85	•		•	