

Tube Fittings & Adapters

MP-FP Reducer Bushing 5406 Series

SAE # 140140

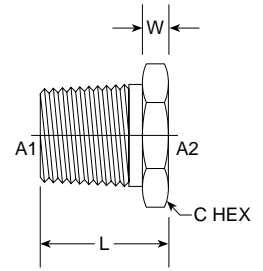

PART NO. SIZE	PIPE O.D.	A1 NPTF	A2 NPTF	L LGTH	M.M.	W WIDTH	M.M.	C HEX	C HEX	M.M.	Standard Material From Stock			
											S	FG	SS	B
5406-04-02	1/4	1/4-18	1/8-27	0.859	21.82	0.250	6.35	5/8	0.625	15.88	•		•	•
5406-06-02	3/8	3/8-18	1/8-27	0.859	21.82	0.250	6.35	3/4	0.750	19.05	•		•	•
5406-06-04	3/8	3/8-18	1/4-18	0.859	21.82	0.250	6.35	3/4	0.750	19.05	•		•	•
5406-08-02	1/2	1/2-14	1/8-27	1.109	28.17	0.310	7.87	7/8	0.875	22.23	•		•	•
5406-08-04	1/2	1/2-14	1/4-18	1.109	28.17	0.310	7.87	7/8	0.875	22.23	•		•	•
5406-08-06	1/2	1/2-14	3/8-18	1.109	28.17	0.310	7.87	7/8	0.875	22.23	•		•	•
5406-12-02	3/4	3/4-14	1/8-27	1.171	29.74	0.380	9.65	1 1/8	1.125	28.58	•		•	•
5406-12-04	3/4	3/4-14	1/4-18	1.171	29.74	0.380	9.65	1 1/8	1.125	28.58	•		•	•
5406-12-06	3/4	3/4-14	3/8-18	1.171	29.74	0.380	9.65	1 1/8	1.125	28.58	•		•	•
5406-12-08	3/4	3/4-14	1/2-14	1.171	29.74	0.380	9.65	1 1/8	1.125	28.58	•		•	•
5406-16-02	1	1-11 1/2	1/8-27	1.359	34.52	0.380	9.65	1 3/8	1.375	34.93	•		•	•
5406-16-04	1	1-11 1/2	1/4-18	1.359	34.52	0.380	9.65	1 3/8	1.375	34.93	•		•	•
5406-16-06	1	1-11 1/2	3/8-18	1.359	34.52	0.380	9.65	1 3/8	1.375	34.93	•		•	•
5406-16-08	1	1-11 1/2	1/2-14	1.359	34.52	0.380	9.65	1 3/8	1.375	34.93	•		•	•
5406-16-12	1	1-11 1/2	3/4-14	1.359	34.52	0.380	9.65	1 3/8	1.375	34.93	•		•	•
5406-20-04	1 1/4	1 1/4-11 1/2	1/4-18	1.470	37.34	0.460	11.68	1 3/4	1.750	44.45	•		•	•
5406-20-06	1 1/4	1 1/4-11 1/2	3/8-18	1.470	37.34	0.460	11.68	1 3/4	1.750	44.45	•		•	•
5406-20-08	1 1/4	1 1/4-11 1/2	1/2-14	1.470	37.34	0.460	11.68	1 3/4	1.750	44.45	•		•	•
5406-20-12	1 1/4	1 1/4-11 1/2	3/4-14	1.470	37.34	0.460	11.68	1 3/4	1.750	44.45	•		•	•
5406-20-16	1 1/4	1 1/4-11 1/2	1-11 1/2	1.470	37.34	0.460	11.68	1 3/4	1.750	44.45	•		•	•
NEW 5406-24-02	1 1/2	1 1/2-11 1/2	1/4-18	1.570	39.88	0.530	13.46	2	2.000	50.80	•		•	•
5406-24-04	1 1/2	1 1/2-11 1/2	3/8-18	1.570	39.88	0.530	13.46	2	2.000	50.80	•		•	•
5406-24-06	1 1/2	1 1/2-11 1/2	1/2-14	1.570	39.88	0.530	13.46	2	2.000	50.80	•		•	•
5406-24-08	1 1/2	1 1/2-11 1/2	3/4-14	1.570	39.88	0.530	13.46	2	2.000	50.80	•		•	•
5406-24-12	1 1/2	1 1/2-11 1/2	1-11 1/2	1.570	39.88	0.530	13.46	2	2.000	50.80	•		•	•
5406-24-16	1 1/2	1 1/2-11 1/2	1 1/4-11 1/2	1.570	39.88	0.530	13.46	2	2.000	50.80	•		•	•
5406-24-20	1 1/2	1 1/2-11 1/2	1 1/4-11 1/2	1.570	39.88	0.530	13.46	2	2.000	50.80	•		•	•
5406-32-04	2	2-11 1/2	1/4-18	1.750	44.45	0.680	17.27	2 1/2	2.500	63.50	•		•	•
5406-32-06	2	2-11 1/2	3/8-18	1.750	44.45	0.680	17.27	2.5	2.500	63.50	•		•	•
5406-32-08	2	2-11 1/2	1/2-14	1.750	44.45	0.680	17.27	2 1/2	2.500	63.50	•		•	•
5406-32-12	2	2-11 1/2	3/4-14	1.750	44.45	0.680	17.27	2 1/2	2.500	63.50	•		•	•
5406-32-16	2	2-11 1/2	1-11 1/2	1.750	44.45	0.680	17.27	2 1/2	2.500	63.50	•		•	•
5406-32-20	2	2-11 1/2	1 1/4-11 1/2	1.750	44.45	0.680	17.27	2 1/2	2.500	63.50	•		•	•
5406-32-24	2	2-11 1/2	1 1/2-11 1/2	1.750	44.45	0.680	17.27	2 1/2	2.500	63.50	•		•	•

Pipe Cap 5406-C Series

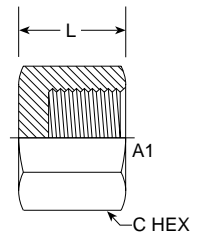

PART NO. SIZE	PIPE O.D.	A1 NPTF	L LGTH	M.M.	C HEX	C HEX	M.M.	Standard Material From Stock				
								S	FG	SS	B	
5406-C-02	1/8	1/8-27	0.550	13.97	9/16	0.562	14.28	•				
5406-C-04	1/4	1/4-18	0.810	20.57				•				
5406-C-06	3/8	3/8-18	0.810	20.57	13/16	0.812	20.66	•				
5406-C-08	1/2	1/2-14	1.000	25.40	1	1.000	25.40	•				
5406-C-12	3/4	3/4-14	1.130	28.70	1 3/16	1.188	30.17	•				
5406-C-16	1	1-11 1/2	1.150	29.21	1 1/2	1.500	38.10	•				
5406-C-20	1 1/2	1 1/4-11 1/2	1.250	31.75	2	2.000	50.80	•			•	