

Tube Fittings & Adapters

MP-BW Weld-on Fitting 316SS 5316 Series

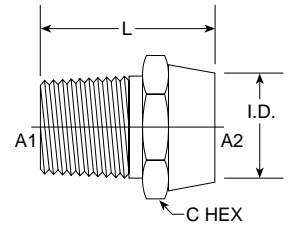

PART NO. SIZE	PIPE O.D.	A1 NPTF	A2 WELD-ON	I.D.	M.M.	L LGTH M.M.	C HEX	C HEX	M.M.	Standard Material From Stock				
										S	FG	SS	B	
5316-04	1/4	1/4-18	1/4	0.250	6.35	1.197	30.40	9/16	0.562	14.28			•	
5316-06	3/8	3/8-18	3/8	0.375	9.52	1.250	31.75	11/16	0.687	17.46			•	
5316-08	1/2	1/2-14	1/2	0.500	12.70	1.438	36.52	7/8	0.875	22.22			•	
5316-12	3/4	3/4-14	3/4	0.750	19.05	1.500	38.10	1 1/16	1.062	26.99			•	
5316-16	1	1-11 1/2	1	1.000	25.40	1.700	43.18	1 5/16	1.312	33.33			•	

MP-MP Hex Nipple 5404 Series

SAE # 140137

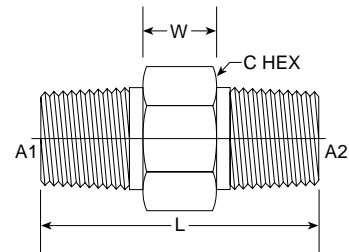

PART NO. SIZE	PIPE O.D.	A1 NPTF	A2 NPTF	L LGTH M.M.	W WIDTH M.M.	C HEX	C HEX	M.M.	Standard Material From Stock					
									S	FG	SS	B		
5404-02-02	1/8	1/8-27	1/8-27	1.060	26.92	0.220	5.59	7/16	0.438	11.13	•		•	•
5404-04-02	1/4	1/4-18	1/8-27	1.260	32.00	0.250	6.35	9/16	0.562	14.27	•		•	•
5404-04-04	1/4	1/4-18	1/4-18	1.450	36.83	0.250	6.35	5/8	0.562	14.27	•		•	•
5404-06-02	3/8	3/8-18	1/8-27	1.265	32.13	0.250	6.35	11/16	0.750	19.05	•		•	•
5404-06-04	3/8	3/8-18	1/4-18	1.450	36.83	0.250	6.35	11/16	0.750	19.05	•		•	•
5404-06-06	3/8	3/8-18	3/8-18	1.450	36.83	0.250	6.35	11/16	0.687	17.45	•		•	•
5404-08-04	1/2	1/2-14	1/4-18	1.700	43.18	0.310	7.87	7/8	0.875	22.23	•		•	•
5404-08-06	1/2	1/2-14	3/8-18	1.700	43.18	0.310	7.87	7/8	0.875	22.23	•		•	•
5404-08-08	1/2	1/2-14	1/2-14	1.890	48.01	0.310	7.87	7/8	0.875	22.23	•		•	•
5404-12-04	3/4	3/4-14	1/4-18	1.770	44.96	0.380	9.65	1 1/8	1.125	28.58	•		•	•
5404-12-06	3/4	3/4-14	3/8-18	1.770	44.96	0.380	9.65	1 1/8	1.125	28.58	•		•	•
5404-12-08	3/4	3/4-14	1/2-14	1.960	49.78	0.380	9.65	1 1/8	1.125	28.58	•		•	•
5404-12-12	3/4	3/4-14	3/4-14	1.960	49.78	0.380	9.65	1 1/8	1.125	28.58	•		•	•
5404-16-04	1	1-11 1/2	1/4-18	1.960	49.78	0.380	9.65	1 3/8	1.375	34.93	•		•	•
5404-16-06	1	1-11 1/2	3/8-18	1.970	50.04	0.380	9.65	1 3/8	1.375	34.93	•		•	•
5404-16-08	1	1-11 1/2	1/2-14	2.150	54.61	0.380	9.65	1 3/8	1.375	34.93	•		•	•
5404-16-12	1	1-11 1/2	3/4-14	2.156	54.76	0.380	9.65	1 3/8	1.375	34.93	•		•	•
5404-16-16	1	1-11 1/2	1-11 1/2	2.340	59.44	0.380	9.65	1 3/8	1.375	34.93	•		•	•
5404-20-12	1 1/4	1 1/4-11 1/2	3/4-14	2.410	61.21	0.460	11.68	1 3/4	1.750	44.45	•		•	•
5404-20-16	1 1/4	1 1/4-11 1/2	1-11 1/2	2.450	62.23	0.460	11.68	1 3/4	1.750	44.45	•		•	•
5404-20-20	1 1/4	1 1/4-11 1/2	1 1/4-11 1/2	2.480	62.99	0.460	11.68	1 3/4	1.750	44.45	•		•	•
5404-24-12	1 1/2	1 1/2-11 1/2	3/4-14	2.380	60.45	0.530	13.46	2	2.000	50.80	•		•	•
5404-24-16	1 1/2	1 1/2-11 1/2	1-11 1/2	2.560	65.02	0.530	13.46	2	2.000	50.80	•		•	•
5404-24-20	1 1/2	1 1/2-11 1/2	1 1/4-11 1/2	2.590	65.79	0.530	13.46	2	2.000	50.80	•		•	•
5404-24-24	1 1/2	1 1/2-11 1/2	1 1/2-11 1/2	2.610	66.29	0.530	13.46	2	2.000	50.80	•		•	•
NEW 5404-32-12											•		•	•
5404-32-16	2	2-11 1/2	1-11 1/2	2.710	68.83	0.680	17.27	2 1/2	2.500	63.50	•		•	•
5404-32-20	2	2-11 1/2	1 1/4-11 1/2	2.760	70.10	0.680	17.27	2 1/2	2.500	63.50	•		•	•
5404-32-24	2	2-11 1/2	1 1/2-11 1/2	2.760	70.10	0.680	17.27	2 1/2	2.500	63.50	•		•	•
5404-32-32	2	2-11 1/2	2-11 1/2	2.820	71.63	0.680	17.27	2 1/2	2.500	63.50	•		•	•
NEW 5404-40-40											•		•	•