

# Tube Fittings & Adapters

## PL-FP Straight 2119 Series

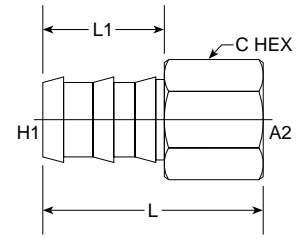

PART NO. SIZE	PIPE O.D.	H1 HOSE I.D.	A2 NPTF	L LGTH	M.M.	L1 LGTH	M.M.	C HEX	C HEX	M.M.	Standard Material From Stock			
											S	FG	SS	B
2119-04-02	1/8	1/4	1/8-27	1.340	34.04	0.700	17.78	1/2	0.055	12.70				•
2119-04-04	1/4	1/4	1/4-18	1.410	35.81	0.700	17.78	5/8	0.625	15.87				•
NEW 2119-04-06														•
2119-06-04	1/4	3/8	1/4-18	1.630	41.40	0.940	23.88	5/8	0.625	15.87				•
2119-06-06	3/8	3/8	3/8-18	1.530	38.86	0.830	21.08	13/16	0.812	20.63				•
NEW 2119-06-08														•
2119-08-06	3/8	1/2	3/8-18	1.730	43.94	1.020	25.91	13/16	.812	20.63				•
2119-08-08	1/2	1/2	1/2-14	1.750	44.45	0.925	23.49	15/16	0.938	23.83				•

## PL-MP 90° Elbow 2120 Series

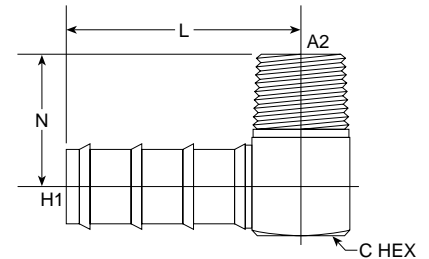

PART NO. SIZE	PIPE O.D.	H1 HOSE I.D.	A2 NPTF	L LGTH	M.M.	N LGTH	M.M.	C HEX	C HEX	M.M.	Standard Material From Stock			
											S	FG	SS	B
2120-04-02	1/8	1/4	1/8-27	0.990	25.15	0.750	19.05	1/2	0.500	12.70				•
2120-04-04	1/4	1/4	1/4-18	1.010	25.65	0.900	22.86	9/16	0.562	14.27				•
2120-06-02	1/8	3/8	1/8-27	1.120	28.45	0.750	19.05	1/2	0.500	12.70				•
2120-06-04	1/4	3/8	1/4-18	1.140	28.96	0.908	23.06	9/16	0.562	14.27				•
2120-06-06	3/8	3/8	3/8-18	1.205	30.61	0.905	22.99	11/16	0.688	17.46				•
2120-06-08	1/2	3/8	1/2-14	1.310	33.27	1.185	30.10	7/8	0.875	22.22				•
2120-08-06	3/8	1/2	3/8-18	1.387	35.20	0.900	22.86	11/16	0.688	17.46				•
2120-08-08	1/2	1/2	1/2-14	1.490	37.85	1.180	29.97	7/8	0.875	22.22				•
NEW 2120-10-08														•
2120-12-12	3/4	3/4	3/4-14	2.070	52.58	1.270	32.26	1 1/16	1.062	26.98				•