

Tube Fittings & Adapters

MJ-Flange Straight Code 62 1800 Series

SAE # J 5 1 8

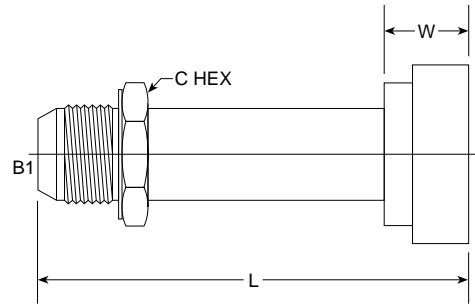

| PART NO. SIZE | TUBE O.D. | FLANGE SIZE | B1 SAE 37 | L LGTH M.M. | W* WIDTH M.M. | C HEX M.M. | C HEX M.M. | C HEX M.M. | Standard Material From Stock | | | | | |
|----------------|-----------|-------------|-----------|-------------|---------------|------------|------------|------------|------------------------------|-------|----|---|--|--|
| | | | | | | | | | S | FG | SS | B | | |
| 1800-12-12 | 3/4 | 3/4 | 1 1/16-12 | 2.570 | 65.28 | 0.690 | 17.53 | 1 1/8 | 1.125 | 28.57 | • | | | |
| 1800-12-16 | 3/4 | 3/4 | 1 1/16-12 | 2.930 | 74.42 | 0.810 | 20.57 | 1 1/8 | 1.125 | 28.57 | • | | | |
| 1800-16-16 | 1 | 1 | 1 5/16-12 | 2.900 | 73.66 | 0.810 | 20.57 | 1 3/8 | 1.375 | 34.92 | • | | | |
| 1800-16-20 | 1 | 1 1/4 | 1 5/16-12 | 2.880 | 73.15 | 1.000 | 25.40 | 1 3/8 | 1.375 | 34.92 | • | | | |
| 1800-16-24 | 1 | 1 1/2 | 1 5/16-12 | 4.026 | 102.26 | 1.190 | 30.23 | 1 3/8 | 1.375 | 34.93 | • | | | |
| 1800-20-16 | 1 1/4 | 1 | 1 5/8-12 | 2.950 | 74.93 | 0.810 | 20.57 | 1 11/16 | 1.687 | 42.86 | • | | | |
| 1800-20-20 | 1 1/4 | 1 1/4 | 1 5/8-12 | 3.123 | 79.32 | 1.000 | 25.40 | 1 11/16 | 1.688 | 42.88 | • | | | |
| 1800-20-24 | 1 1/4 | 1 1/2 | 1 5/8-12 | 4.170 | 105.92 | 1.190 | 30.23 | 1 3/4 | 1.75 | 44.45 | • | | | |
| 1800-24-20 | 1 1/2 | 1 1/4 | 1 7/8-12 | 2.240 | 56.90 | 1.000 | 25.40 | 2 3/64 | 2.047 | 51.99 | • | | | |
| 1800-24-24 | 1 1/2 | 1 1/2 | 1 7/8-12 | 2.288 | 58.12 | 1.190 | 30.23 | 2 | 2.000 | 50.80 | • | | | |
| NEW 1800-32-32 | | | | | | | | | | | • | | | |

MJ-Flange 45° Code 62 1803 Series

SAE # J 5 1 8

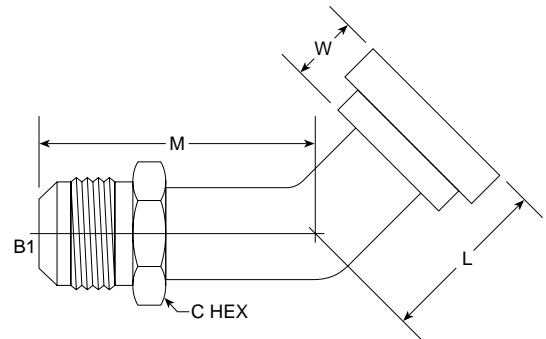

| PART NO. SIZE | TUBE O.D. | FLANGE SIZE | B1 SAE 37 | L LGTH M.M. | M LGTH M.M. | W* WIDTH M.M. | C HEX M.M. | C HEX M.M. | C HEX M.M. | Standard Material From Stock | | | | | | |
|----------------|-----------|-------------|-----------|-------------|-------------|---------------|------------|------------|------------|------------------------------|-------|-------|---|--|--|--|
| | | | | | | | | | | S | FG | SS | B | | | |
| 1803-08-08 | 1/2 | 1/2 | 3/4-16 | 1.100 | 27.94 | 1.600 | 40.64 | 0.560 | 14.22 | 13/16 | 0.812 | 20.62 | • | | | |
| 1803-12-12 | 3/4 | 3/4 | 1 1/16-12 | 1.400 | 35.56 | 1.800 | 45.72 | 0.690 | 17.53 | 1 1/8 | 1.125 | 28.57 | • | | | |
| 1803-12-20 | 3/4 | 1 1/4 | 1 1/16-12 | 2.000 | 50.80 | 2.190 | 55.63 | 1.000 | 25.40 | 1 1/4 | 1.25 | 31.75 | • | | | |
| 1803-12-16 | 3/4 | 1 | 1 1/16-12 | 1.400 | 35.56 | 1.900 | 48.26 | 0.812 | 20.57 | 1 7/64 | 1.109 | 28.17 | • | | | |
| 1803-16-12 | 1 | 3/4 | 1 5/16-12 | 1.560 | 39.62 | 2.400 | 60.96 | 1.190 | 30.23 | 1 3/8 | 1.375 | 34.93 | • | | | |
| 1803-16-16 | 1 | 1 | 1 5/16-12 | 1.800 | 45.72 | 2.200 | 55.88 | 0.812 | 20.57 | 1 3/8 | 1.375 | 34.92 | • | | | |
| 1803-16-20 | 1 | 1 1/4 | 1 5/16-12 | 1.400 | 35.56 | 2.000 | 50.80 | 1.000 | 25.40 | 1 3/8 | 1.375 | 34.92 | • | | | |
| NEW 1803-16-24 | | | | | | | | | | | | | • | | | |
| NEW 1803-20-12 | | | | | | | | | | | | | • | | | |
| 1803-20-16 | 1 1/4 | 1 | 1 5/8-12 | 1.550 | 39.37 | 2.020 | 51.31 | 0.810 | 20.57 | 1 11/16 | 1.688 | 42.88 | • | | | |
| 1803-20-20 | 1 1/4 | 1 1/4 | 1 5/8-12 | 2.170 | 55.12 | 2.190 | 55.63 | 1.000 | 25.40 | 2 | 2.000 | 50.80 | • | | | |
| 1803-20-24 | 1 1/2 | 1 1/2 | 1 7/8-12 | 1.700 | 43.18 | 2.500 | 63.50 | 1.190 | 30.23 | 2 3/64 | 2.046 | 51.97 | • | | | |
| 1803-24-20 | 1 1/2 | 1 1/4 | 1 7/8-12 | 1.500 | 38.10 | 2.330 | 59.18 | 1.000 | 25.40 | 2 3/64 | 2.047 | 51.99 | • | | | |
| 1803-24-24 | 1 1/2 | 1 1/2 | 1 7/8-12 | 2.400 | 60.96 | 3.430 | 87.12 | 1.190 | 30.23 | 2 | 2.000 | 50.80 | • | | | |
| 1803-32-32 | 2 | 2 | 1 1/2-12 | 2.600 | 66.04 | 3.200 | 81.28 | 1.500 | 38.10 | 2 3/4 | 2.750 | 69.87 | • | | | |

*Note: Fitting design beyond dimension "W" is optional providing that adequate clearance for installing bolts is maintained.