

Tube Fittings & Adapters

MJ-Flange 45° Code 61 1703 Series

SAE# J 518

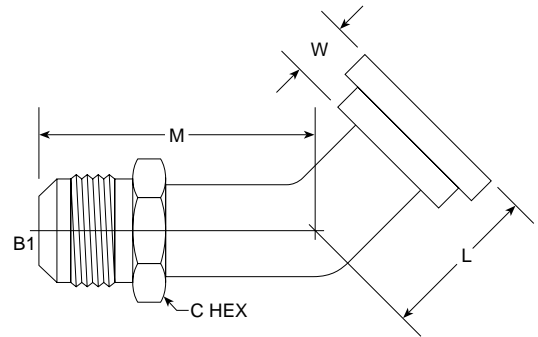

PART NO.	NO. SIZE	TUBE O.D.	FLANGE SIZE	B1 SAE 37	L LGTH M.M.	M LGTH M.M.	W* WIDTH M.M.	C HEX	C HEX	M.M.	Standard Material From Stock						
											S	FG	SS	B			
NEW	1703-08-08	1/2	1/2	3/4-16	1.080	27.43	1.770	44.96	0.500	12.70	13/16	0.812	20.62	•			
	1703-08-12													•			
	1703-12-12	3/4	3/4	1 1/16-12	1.500	38.10	1.650	41.93	0.560	14.22	1 1/8	1.125	28.57	•			
	1703-12-16	3/4	1	1 1/16-12	1.300	33.02	1.850	46.99	0.560	14.22	1 1/8	1.125	28.57	•			
NEW	1703-12-20													•			
NEW	1703-16-12													•			
	1703-16-16	1	1	1 5/16-12	1.400	35.56	2.200	55.88	0.560	14.22	1 3/8	1.375	34.92	•			
NEW	1703-16-20													•			
NEW	1703-16-24													•			
NEW	1703-20-16													•			
	1703-20-20	1 1/4	1 1/4	1 5/8-12	1.300	33.02	2.350	59.69	0.560	14.22	1 11/16	1.687	42.85	•			
NEW	1703-24-16													•			
	1703-20-24	1 1/4	1 1/2	1 5/8-12	1.750	44.45	2.000	50.80	0.560	14.22	1 11/16	1.687	42.85	•			
NEW	1703-24-20													•			
	1703-24-24	1 1/2	1 1/2	1 7/8-12	1.600	40.64	2.300	58.42	0.620	15.75	2	2.000	50.80	•			
	1703-32-32	2	2	2 1/2-12	1.700	43.18	2.900	73.66	0.620	15.75	2 5/8	2.625	66.68	•			

*Note: Fitting design beyond dimension "W" is optional providing that adequate clearance for installing bolts is maintained.