

MP-FPS-FPS Tee 1601 Series

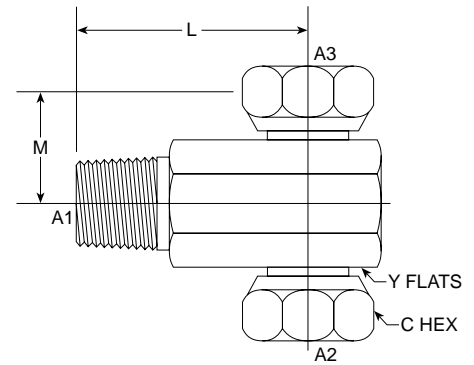

PART NO. SIZE	TUBE O.D.	A1 NPTF	A2 NPSM	A3 NPSM	L		M		C HEX	C HEX M.M.	Y FLATS	Y FLATS M.M.	Standard Material From Stock					
					LGTH	M.M.	LGTH	M.M.					S	FG	SS	B		
1601-02-02-02	1/8	1/8-27	1/8-27	1/8-27	0.940	23.88	0.690	17.53	9/16	0.562	14.27	9/16	0.562	14.27	•			
1601-02-04-04	1/8	1/8-27	1/4-18	1/4-18	1.190	30.23	0.712	18.08	11/16	0.687	17.45	11/16	0.687	17.45	•			
1601-04-04-04	1/4	1/4-18	1/4-18	1/4-18	1.190	30.23	0.750	19.05	11/16	0.687	17.45	11/16	0.687	17.45	•			
1601-04-06-06	1/4	1/4-18	3/8-18	3/8-18	1.500	38.10	0.822	20.88	7/8	0.875	22.23	7/8	0.875	22.23	•			
1601-06-04-04	3/8	3/8-18	1/4-18	1/4-18	1.500	38.10	0.872	22.15	11/16	0.687	17.45	7/8	0.875	22.23	•			
1601-06-06-06	3/8	3/8-18	3/8-18	3/8-18	1.500	38.10	0.940	23.88	7/8	0.875	22.23	7/8	0.875	22.23	•	•		
1601-08-04-04	1/2	1/2-14	1/4-18	1/4-18	1.750	44.45	0.937	23.80	11/16	0.687	17.45	1	1.000	25.40	•			
1601-08-06-06	1/2	1/2-14	3/8-18	3/8-18	1.750	44.45	1.000	25.40	7/8	0.875	22.23	1	1.000	25.40	•			
1601-08-08-08	1/2	1/2-14	1/2-14	1/2-14	1.810	45.97	1.000	25.40	1	1.000	25.40	1	1.000	25.40	•		•	
1601-12-08-08	3/4	3/4-14	1/2-14	1/2-14	2.000	50.80	2.125	53.98	1	1.000	25.40	1 1/4	1.250	31.75	•			
1601-12-12-12	3/4	3/4-14	3/4-14	3/4-14	2.000	50.80	1.190	30.23	1 1/4	1.250	31.75	1 1/4	1.250	31.75	•			
1601-12-16-16	3/4	3/4-14	1-11 1/2	1-11 1/2	2.000	50.80	1.390	35.31	1 1/2	1.500	38.10	1 1/2	1.500	38.10	•			
1601-16-12-12	1	1-11 1/2	3/4-14	3/4-14	2.375	60.33	1.338	33.99	1 1/4	1.250	31.75	1 1/2	1.500	38.10	•			
1601-16-16-16	1	1-11 1/2	1-11 1/2	1-11 1/2	2.380	60.45	1.440	36.58	1 1/2	1.500	38.10	1 1/2	1.500	38.10	•			
1601-20-20-20	1 1/4	1 1/4-11 1/2	1 1/4-11 1/2	1 1/4-11 1/2	2.620	66.55	1.620	41.15	1 7/8	1.875	47.63	1 7/8	1.875	47.63	•			
1601-24-24-24	1 1/2	1 1/2-11 1/2	1 1/2-11 1/2	1 1/2-11 1/2	2.810	71.37	1.750	44.45	2 1/8	2.125	53.98	2 1/8	2.125	53.98	•			

FP-FPS-FPS Tee 1602 Series

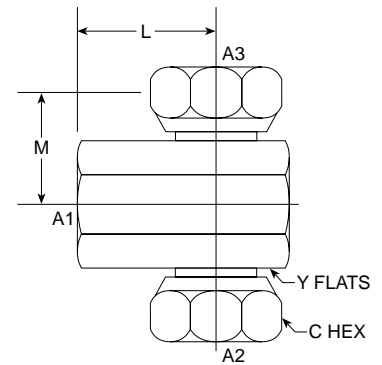

PART NO. SIZE	TUBE O.D.	A1 NPTF	A2 NPSM	A3 NPSM	L		M		C HEX	C HEX M.M.	Y FLATS	Y FLATS M.M.	Standard Material From Stock					
					LGTH	M.M.	LGTH	M.M.					S	FG	SS	B		
1602-02-02-02	1/8	1/8-27	1/8-27	1/8-27	0.656	16.66	0.687	17.45	9/16	0.562	14.27	9/16	0.562	14.27	•			
1602-04-04-04	1/4	1/4-18	1/4-18	1/4-18	0.937	23.80	0.781	19.84	11/16	0.687	17.45	11/16	0.687	17.45	•			
1602-06-04-04	3/8	3/8-18	1/4-18	1/4-18	1.062	26.97	0.872	22.15	11/16	0.687	17.45	7/8	0.875	22.23	•			
1602-06-06-06	3/8	3/8-18	3/8-18	3/8-18	0.937	23.80	1.062	26.97	7/8	0.875	22.23	7/8	0.875	22.23	•			
1602-08-06-06	1/2	1/2-14	3/8-18	3/8-18	1.250	31.75	1.000	25.40	7/8	0.875	22.23	1	1.000	25.40	•			
1602-08-08-08	1/2	1/2-14	1/2-14	1/2-14	1.000	25.40	1.250	31.75	1	1.000	25.40	1	1.000	25.40	•			
1602-08-12-12	1/2	1/2-14	3/4-14	3/4-14	1.250	31.75	1.437	36.50	1 1/4	1.250	31.75	1 1/4	1.250	31.75	•			
1602-12-08-08	3/4	3/4-14	1/2-14	1/2-14	1.437	36.50	1.125	28.58	1	1.000	25.40	1 1/4	1.250	31.75	•			
1602-12-12-12	3/4	3/4-14	3/4-14	3/4-14	1.250	31.75	1.437	36.50	1 1/4	1.250	31.75	1 1/4	1.250	31.75	•			
1602-16-12-12	1	1-11 1/2	3/4-14	3/4-14	1.750	44.45	1.375	34.93	1 1/4	1.250	31.75	1 1/2	1.500	38.10	•			
1602-16-16-16	1	1-11 1/2	1-11 1/2	1-11 1/2	1.755	44.58	1.390	35.31	1 1/2	1.500	38.10	1 1/2	1.500	38.10	•			
1602-20-20-20	1 1/4	1 1/4-11 1/2	1 1/4-11 1/2	1 1/4-11 1/2	2.000	50.80	1.656	42.06	1 7/8	1.875	47.63	1 7/8	1.875	47.63	•			