

Tube Fittings & Adapters

Bore-MJ Straight 0403 Series

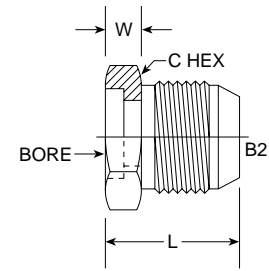

PART NO. SIZE	TUBE O.D.	B2 THREAD	BORE	L LGTH M.M.	W WIDTH M.M.	C HEX M.M.	C HEX M.M.	M.M.	Standard Material From Stock					
									S	FG	SS	B		
0403-04-04	1/4	7/16-20	1/4	0.796	20.22	0.220	15.59	1/2	0.500	12.70	•		•	
0403-05-04	5/16	1/2-20	5/16	0.796	20.22	0.220	5.59	1/2	0.500	12.70	•		•	
0403-05-05	5/16	1/2-20	5/16	0.796	20.22	0.220	5.59	9/16	0.562	14.27	•		•	
0403-06-06	3/8	9/16-18	3/8	0.843	21.41	0.250	6.35	5/8	0.625	15.88	•		•	
0403-06-08	3/8	3/4-16	3/8	0.937	23.80	0.250	6.35	13/16	0.812	20.62	•		•	
NEW 0403-08-06											•		•	
0403-08-08	1/2	3/4-16	1/2	0.937	23.80	0.250	6.35	13/16	0.812	20.62	•		•	
0403-08-10	1/2	7/8-14	1/2	1.093	27.76	0.310	7.87	15/16	0.937	23.80	•		•	
0403-10-08	5/8	3/4-16	5/8	0.937	23.80	0.250	6.35	15/16	0.937	23.80	•		•	
0403-10-10	5/8	7/8-14	5/8	1.093	27.76	0.310	7.87	15/16	0.937	23.80	•		•	
0403-10-12	5/8	1 1/16-12	5/8	1.281	32.54	0.380	9.65	1 1/4	1.250	31.75	•		•	
0403-12-08	3/4	3/4-16	3/4	0.937	23.80	0.380	9.65	1 1/4	1.250	31.75	•		•	
0403-12-10	3/4	7/8-14	3/4	1.093	27.76	0.380	9.65	1 1/4	1.250	31.75	•		•	
0403-12-12	3/4	1 1/16-12	3/4	1.281	32.54	0.380	9.65	1 1/4	1.250	31.75	•		•	
0403-14-14	7/8	1 3/16-12	7/8	1.312	33.32	0.380	9.65	1 1/2	1.500	38.10	•		•	
0403-16-12	1	1 1/16-12	1	1.281	32.54	0.380	9.65	1 3/8	1.375	34.93	•		•	
0403-16-16	1	1 5/16-12	1	1.328	33.73	0.380	9.65	1 3/8	1.375	34.93	•		•	
0403-16-20	1	1 5/8-12	1	1.453	36.91	0.460	11.68	1 11/16	1.688	42.86	•		•	
0403-20-16	1 1/4	1 5/16-12	1 1/4	1.328	33.73	0.460	11.68	1 11/16	1.688	42.86	•		•	
0403-20-20	1 1/4	1 5/8-12	1 1/4	1.453	36.91	0.460	11.68	1 11/16	1.688	42.86	•		•	
0403-20-24	1 1/4	1 7/8-12	1 1/4	1.656	42.06	0.530	13.46	2	2.000	50.80	•		•	
0403-24-20	1 1/4	1 5/8-12	1 1/2	1.453	36.91	0.530	13.46	2	2.000	50.80	•		•	
0403-24-24	1 1/2	1 7/8-12	1 1/2	1.656	42.06	0.530	13.46	2	2.000	50.80	•		•	
0403-32-32	2	2 1/2-12	2	2.046	51.97	0.680	17.27	2 5/8	2.625	66.68	•		•	

MJ Tube Spud 0403-TS Series

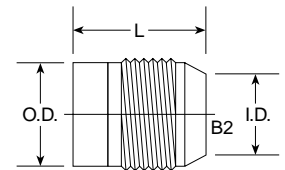

PART NO. SIZE	TUBE O.D.	B2	O.D.	I.D.	Standard Material From Stock			
					S	FG	SS	B
0403-TS-04-04	1/4	7/16-20	0.361	0.172	•			
0403-TS-06-06	3/8	9/16-18	0.471	0.297	•			
0403-TS-08-08	1/2	3/4-16	0.628	0.391	•			
0403-TS-10-10	5/8	7/8-14	0.752	0.484	•			
0403-TS-12-12	3/4	1 1/16-12	0.862	0.609	•			
0403-TS-16-16	1	1 5/8-12	1.159	0.844	•			
0403-TS-20-20	1 1/4	1 5/8-12	1.504	1.078	•			
0403-TS-24-24	1 1/2	1 7/8-12	1.628	1.312	•			