

MFS-Flange Straight Code 61 FS1700 Series

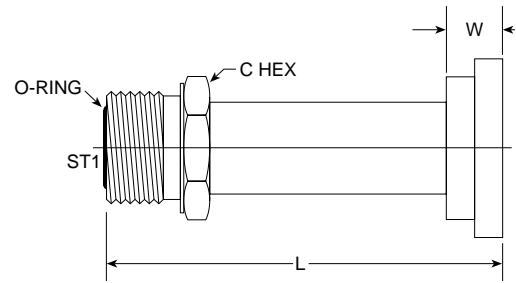

PART NO. SIZE	TUBE O.D.	ST1	FLANGE	L LGTH	M.M.	W WIDTH	M.M.	C HEX	C HEX	M.M.	Standard Material From Stock					
											S	FG	SS	B		
NEW FS1700-12-12																
NEW FS1700-16-16																
NEW FS1700-20-20																
NEW FS1700-24-24																

MFS-Flange 45° Code 61 FS1703 Series

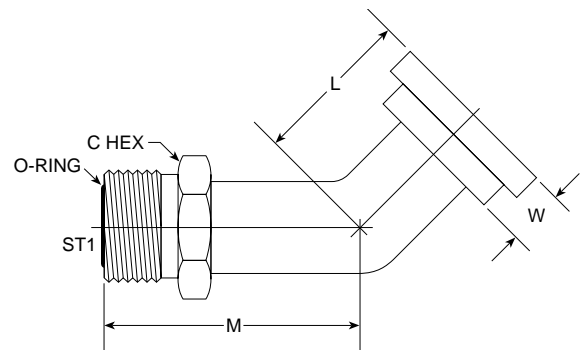

PART NO. SIZE	TUBE O.D.	ST1	FLANGE	L LGTH	M.M.	M LGTH	M.M.	W WIDTH	M.M.	C HEX	C HEX	M.M.	Standard Material From Stock			
													S	FG	SS	B
NEW FS1703-12-12																
NEW FS1703-12-16																
NEW FS1703-16-16																
NEW FS1703-20-20																
NEW FS1703-24-24																

MFS-Flange Straight Code 62 FS1800 Series

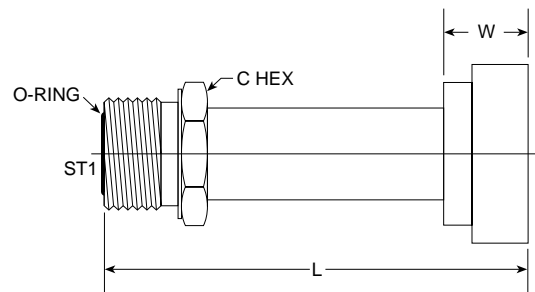

PART NO. SIZE	TUBE O.D.	ST1	FLANGE	L LGTH	M.M.	W WIDTH	M.M.	C HEX	C HEX	M.M.	Standard Material From Stock					
											S	FG	SS	B		
NEW FS1800-12-12																
NEW FS1800-16-12																
NEW FS1800-16-16																
NEW FS1800-20-20																
NEW FS1800-24-24																