

# FABRICATIONS - FLANGES, V-GUIDES, AND EDGE FINISHES

## FLANGES

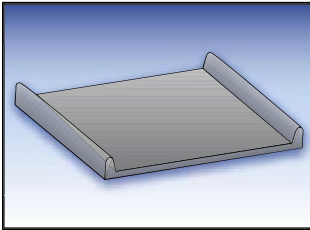

### Flanges - Molded

Prevents product spilling off edge of belt. Free-flowing materials are contained without troughing. Flange belts can be made endless or conventionally laced. *Care must be taken to operate flanged belts on the proper diameter pulleys. Consult factory for recommendations. Corrugated sidewalls available – see pages 32-34.*

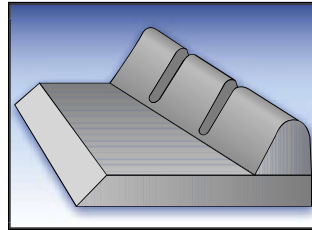

### Flanges - Notched

Notching of the flanges enables a flanged belt to operate on smaller diameter pulleys. Also allows the belt to “back flex” in weighing applications.

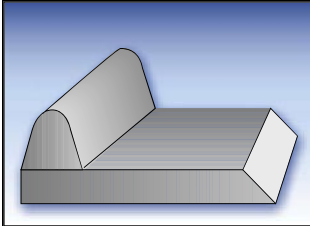

### Flanges - Heights Available

1/2", 3/4", 1", 1-1/2", 2"

### Styles Available

Gumdrop, Tapered One Side, Tapered Both Sides (all styles not available in all heights) Note: Standard flanges are 60 durometer. 40 durometer is available for special applications where smaller than average pulleys are being used.

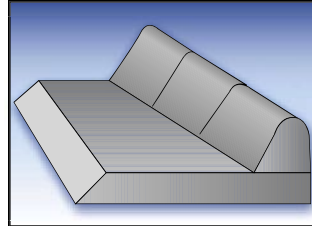

### Flanges - Siped

Siping of flanges enables a flanged belt to operate on smaller diameter pulleys.

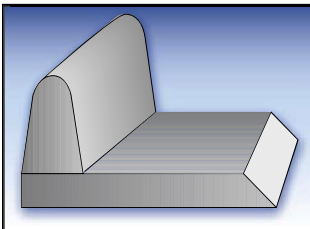

### Flanges - Compounds Available

Black SBR  
Black Nitrile  
White Nitrile  
White PVC  
Black PVC  
White Butyl High Heat  
Black Butyl High Heat

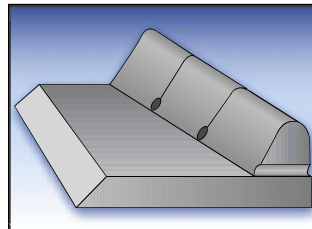

### Flanges - Siped and Drilled

Flanges can be siped into relief holes to prevent any further action of slits to propagate into the belt cover.

## V-GUIDES AND V-BELT BACKING

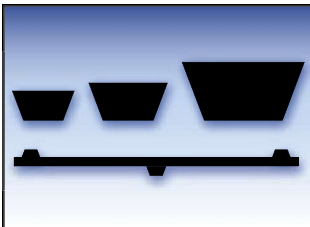

### V-Guides

Used wherever conditions create a belt alignment problem. Can be molded to any belt and be made endless if desired. Bonded to cover side for flanges; bonded to underside for guide. Available in **A** (1/2" W x 5/16" H), **B** (5/8" W x 7/16" H), and **C** (7/8" W x 5/8" H) cross sections. Other sizes available.

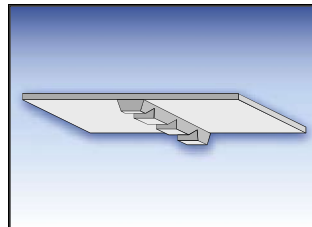

### V-Guides - Notched

Available in A-B-C-D sections, and more. Notching enables a V-guided belt to operate on smaller pulley diameters. The V-guide reduces tracking problems.

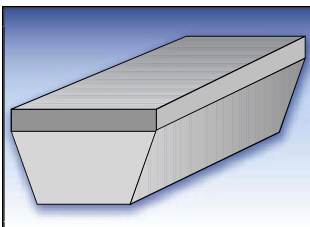

### V-Belt Backing

Covers of pure gum, neoprene sheet rubber, urethane, rough-top belt, white non-marking belt, etc. can be bonded to the back of V-belts.

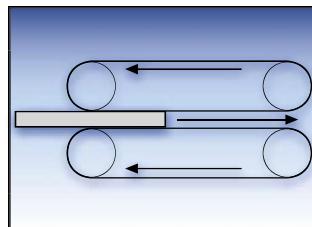

### V-Belt Backing

Recommended where V-belts are used as conveyor or in tandem to pull product or cable in sandwich fashion.

## EDGE FINISHES

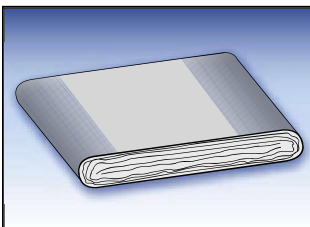

### Folded Edges

Premium construction for superior edge wear and carcass protection. Chemicals and bacteria may not attack the interior plies. Folded edges provide a continuous surface from the top of the belt around the edges.

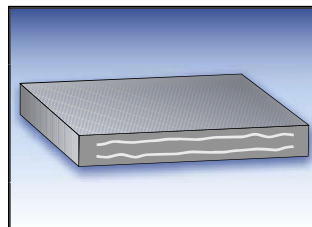

### Molded Edges

Rubber edging vulcanized to cut-edge belting. Protects the belt fabric from bacteria and damaging chemicals. Ideal for food-handling applications. Also used for additional protection from edge wear.